

Friday, July 12, 2019

Tim Grossi
Contoocook Valley School District
106 Hancock Road
Peterborough NH 03458

Project Name: Great Brook Middle School

Lab ID: 19060238

Project #: N/A

Date Received: 6/19/2019

Project Location: SCH-22210

Control #: 19060238

Dear Tim Grossi

Enclosed please find the laboratory results for the above referenced samples that were received by the ChemServe sample custodian on the above referenced date. Any abnormalities to the samples upon receipt would be noted on the enclosed chain of custody document. This report is not valid without a completed chain of custody with the corresponding control number, attached.

All samples analyzed by ChemServe are subject to quality standards. These standards are as stringent or more stringent than those established under NELAC, 40 CFR Part 136, state certification programs, and corresponding methodologies. ChemServe has a written QA/QC Procedures Manual that outlines these standards, and is available for your reference, upon request. Unless otherwise stated on the Chain of Custody or within the report, all holding times, preservation techniques, container types, and analytical methods are analogous with those outlined by NELAC. All units are based on "as received" weight unless denoted "dry".

Residual chlorine, sulfite and pH are intended to be performed as an immediate field analysis. Should any of these analyses be performed in the lab instead of in the field it will result in those analyses being performed out of holding time.

Acrolein and 2-chloroethylvinyl ether require an additional analysis with an un-preserved sample. If unpreserved vials were not submitted for these additional analysis then acrolein and 2-CEVE are reported as estimated due to not meeting method requirements for EPA 624.1 or EPA 524.2.

I certify that I have reviewed the above referenced analytical data and state forms, and I have found this report within compliance with the procedures outlined within NELAC. ChemServe's certified parameter list can be found at <http://www.chemservelab.com/Laboratory-Information-and-Documentation.aspx>

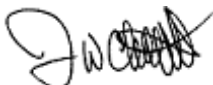

Jay Chrystal - President/Laboratory Director



Contoocook Valley School District

Tim Grossi

106 Hancock Road

Peterborough NH 03458

Control #: 19060238

Project Number: N/A

Project Name: Great Brook Middle School

Project Location: SCH-22210

Lab ID: 19060238

Date: 7/12/2019

Lab ID: 19060238

Sample Receiving and Comment Summary

| | |
|---|-----|
| Were samples submitted with a chain of custody? | Yes |
| Do all samples received match the chain of custody? | Yes |
| Were all samples received within applicable holding times? | Yes |
| Were all containers intact when received? | Yes |
| Were samples for volatile organic analysis free of headspace (per method)? | N/A |
| Was there evidence of cooling if not submitted the same day as sampling? | Yes |
| If the sample pH was not correct was it adjusted where applicable? | Yes |
| Were samples for dissolved metals already filtered by the client or field sampling? | N/A |
| Were Samples for O-phos filtered in the field? | N/A |
| Were samples received in the appropriate containers? | Yes |
| Where applicable; were chemical and micro samples received at correct temps. | Yes |

| Sample | Method | Client Identity | Matrix | Analyst |
|--------------|-------------------|-----------------|----------------|-----------|
| 19060238-001 | EPA 200.5 Rev 4.2 | Office BR Sink | Drinking Water | CharleneF |

Comment: no comment

* Blank comment sections denote "No Comment"



317 Elm Street
 Milford, NH 03055
 (603) 673-5440
 Sales@chemservelab.com

Contocook Valley School District
 Tim Grossi
 106 Hancock Road
 Peterborough NH 03458

Control #: 19060238
 Project Number: N/A
 Project Name: Great Brook Middle School
 Project Location: SCH-22210

Analytical Results
Lab ID: 19060238
Date: 7/12/2019

| Sample | Method | Client Sample Identity | Units | Matrix | Analyst |
|--------------|-------------------|------------------------|-------|----------------|-----------|
| 19060238-001 | EPA 200.5 Rev 4.2 | Office BR Sink | | Drinking Water | CharleneF |

Start Date/Time Sampled: 6/19/2019 8:40:00 AM Composite End Date/Time:

| Parameter | CAS Number | Result | Qualifier | Date/Time Analyzed | RDL | Analyst |
|---------------------|------------|--------------|-----------|--------------------|-------|----------|
| Hot Plate Digestion | | | | 6/21/2019 | 0 | harleneF |
| Lead | 7439-92-1 | < 0.003 mg/L | | 6/26/2019 | 0.003 | BenN |

| Sample | Method | Client Sample Identity | Units | Matrix | Analyst |
|--------------|-------------------|------------------------|-------|----------------|-----------|
| 19060238-002 | EPA 200.5 Rev 4.2 | Nurses Office Sink | | Drinking Water | CharleneF |

Start Date/Time Sampled: 6/19/2019 8:39:00 AM Composite End Date/Time:

| Parameter | CAS Number | Result | Qualifier | Date/Time Analyzed | RDL | Analyst |
|---------------------|------------|------------|-----------|--------------------|-------|----------|
| Hot Plate Digestion | | | | 6/21/2019 | 0 | harleneF |
| Lead | 7439-92-1 | 0.006 mg/L | | 6/26/2019 | 0.003 | BenN |

| Sample | Method | Client Sample Identity | Units | Matrix | Analyst |
|--------------|-------------------|------------------------------------|-------|----------------|-----------|
| 19060238-003 | EPA 200.5 Rev 4.2 | Hand Wash Basin BRs next to Office | | Drinking Water | CharleneF |

Start Date/Time Sampled: 6/19/2019 8:45:00 AM Composite End Date/Time:

| Parameter | CAS Number | Result | Qualifier | Date/Time Analyzed | RDL | Analyst |
|---------------------|------------|------------|-----------|--------------------|-------|----------|
| Hot Plate Digestion | | | | 6/21/2019 | 0 | harleneF |
| Lead | 7439-92-1 | 0.006 mg/L | | 6/26/2019 | 0.003 | BenN |

| Sample | Method | Client Sample Identity | Units | Matrix | Analyst |
|--------------|-------------------|------------------------|-------|----------------|-----------|
| 19060238-004 | EPA 200.5 Rev 4.2 | WF next to Office/Gym | | Drinking Water | CharleneF |

Start Date/Time Sampled: 6/19/2019 8:40:00 AM Composite End Date/Time:

| Parameter | CAS Number | Result | Qualifier | Date/Time Analyzed | RDL | Analyst |
|---------------------|------------|--------------|-----------|--------------------|-------|----------|
| Hot Plate Digestion | | | | 6/21/2019 | 0 | harleneF |
| Lead | 7439-92-1 | < 0.003 mg/L | | 6/26/2019 | 0.003 | BenN |



317 Elm Street
 Milford, NH 03055
 (603) 673-5440
 Sales@chemservelab.com

| Sample | Method | Client Sample Identity | Units | Matrix | Analyst |
|--------------|-------------------|------------------------|-------|----------------|-----------|
| 19060238-005 | EPA 200.5 Rev 4.2 | Staff Kitchen Sink | | Drinking Water | CharleneF |

Start Date/Time Sampled: 6/19/2019 8:42:00 AM Composite End Date/Time:

| Parameter | CAS Number | Result | Qualifier | Date/Time Analyzed | RDL | Analyst |
|---------------------|------------|------------|-----------|--------------------|-------|----------|
| Hot Plate Digestion | | | | 6/21/2019 | 0 | harleneF |
| Lead | 7439-92-1 | 0.011 mg/L | | 6/26/2019 | 0.003 | BenN |

| Sample | Method | Client Sample Identity | Units | Matrix | Analyst |
|--------------|-------------------|------------------------|-------|----------------|-----------|
| 19060238-006 | EPA 200.5 Rev 4.2 | Staff BR Sink | | Drinking Water | CharleneF |

Start Date/Time Sampled: 6/19/2019 8:44:00 AM Composite End Date/Time:

| Parameter | CAS Number | Result | Qualifier | Date/Time Analyzed | RDL | Analyst |
|---------------------|------------|--------------|-----------|--------------------|-------|----------|
| Hot Plate Digestion | | | | 6/21/2019 | 0 | harleneF |
| Lead | 7439-92-1 | < 0.003 mg/L | | 6/26/2019 | 0.003 | BenN |

| Sample | Method | Client Sample Identity | Units | Matrix | Analyst |
|--------------|-------------------|---------------------------------------|-------|----------------|-----------|
| 19060238-007 | EPA 200.5 Rev 4.2 | Kitchen Rinse Sink Next to 3 Bay Sink | | Drinking Water | CharleneF |

Start Date/Time Sampled: 6/19/2019 8:44:00 AM Composite End Date/Time:

| Parameter | CAS Number | Result | Qualifier | Date/Time Analyzed | RDL | Analyst |
|---------------------|------------|------------|-----------|--------------------|-------|----------|
| Hot Plate Digestion | | | | 6/21/2019 | 0 | harleneF |
| Lead | 7439-92-1 | 0.003 mg/L | | 6/26/2019 | 0.003 | BenN |

| Sample | Method | Client Sample Identity | Units | Matrix | Analyst |
|--------------|-------------------|------------------------|-------|----------------|-----------|
| 19060238-008 | EPA 200.5 Rev 4.2 | Kitchen 3 Bay lft Sink | | Drinking Water | CharleneF |

Start Date/Time Sampled: 6/19/2019 8:45:00 AM Composite End Date/Time:

| Parameter | CAS Number | Result | Qualifier | Date/Time Analyzed | RDL | Analyst |
|---------------------|------------|------------|-----------|--------------------|-------|----------|
| Hot Plate Digestion | | | | 6/21/2019 | 0 | harleneF |
| Lead | 7439-92-1 | 0.013 mg/L | | 6/26/2019 | 0.003 | BenN |

| Sample | Method | Client Sample Identity | Units | Matrix | Analyst |
|--------------|-------------------|------------------------|-------|----------------|-----------|
| 19060238-009 | EPA 200.5 Rev 4.2 | Kitchen 3 Bay rgt Sink | | Drinking Water | CharleneF |

Start Date/Time Sampled: 6/19/2019 8:46:00 AM Composite End Date/Time:

| Parameter | CAS Number | Result | Qualifier | Date/Time Analyzed | RDL | Analyst |
|---------------------|------------|------------|-----------|--------------------|-------|----------|
| Hot Plate Digestion | | | | 6/21/2019 | 0 | harleneF |
| Lead | 7439-92-1 | 0.014 mg/L | | 6/26/2019 | 0.003 | BenN |



317 Elm Street
 Milford, NH 03055
 (603) 673-5440
 Sales@chemservelab.com

| Sample | Method | Client Sample Identity | Units | Matrix | Analyst |
|--------------|-------------------|------------------------|-------|----------------|-----------|
| 19060238-010 | EPA 200.5 Rev 4.2 | Hand wash Sink | | Drinking Water | CharleneF |

Start Date/Time Sampled: 6/19/2019 8:39:00 AM Composite End Date/Time:

| Parameter | CAS Number | Result | Qualifier | Date/Time Analyzed | RDL | Analyst |
|---------------------|------------|--------------|-----------|--------------------|-------|----------|
| Hot Plate Digestion | | | | 6/21/2019 | 0 | harleneF |
| Lead | 7439-92-1 | < 0.003 mg/L | | 6/26/2019 | 0.003 | BenN |

| Sample | Method | Client Sample Identity | Units | Matrix | Analyst |
|--------------|-------------------|------------------------|-------|----------------|-----------|
| 19060238-011 | EPA 200.5 Rev 4.2 | Boys BR Sink | | Drinking Water | CharleneF |

Start Date/Time Sampled: 6/19/2019 8:48:00 AM Composite End Date/Time:

| Parameter | CAS Number | Result | Qualifier | Date/Time Analyzed | RDL | Analyst |
|---------------------|------------|--------------|-----------|--------------------|-------|----------|
| Hot Plate Digestion | | | | 6/21/2019 | 0 | harleneF |
| Lead | 7439-92-1 | < 0.003 mg/L | | 6/26/2019 | 0.003 | BenN |

| Sample | Method | Client Sample Identity | Units | Matrix | Analyst |
|--------------|-------------------|------------------------|-------|----------------|-----------|
| 19060238-012 | EPA 200.5 Rev 4.2 | Girls BR lft Sink | | Drinking Water | CharleneF |

Start Date/Time Sampled: 6/19/2019 8:47:00 AM Composite End Date/Time:

| Parameter | CAS Number | Result | Qualifier | Date/Time Analyzed | RDL | Analyst |
|---------------------|------------|--------------|-----------|--------------------|-------|----------|
| Hot Plate Digestion | | | | 6/21/2019 | 0 | harleneF |
| Lead | 7439-92-1 | < 0.003 mg/L | | 6/26/2019 | 0.003 | BenN |

| Sample | Method | Client Sample Identity | Units | Matrix | Analyst |
|--------------|-------------------|------------------------|-------|----------------|-----------|
| 19060238-013 | EPA 200.5 Rev 4.2 | Girls BR rgt Sink | | Drinking Water | CharleneF |

Start Date/Time Sampled: 6/19/2019 8:48:00 AM Composite End Date/Time:

| Parameter | CAS Number | Result | Qualifier | Date/Time Analyzed | RDL | Analyst |
|---------------------|------------|------------|-----------|--------------------|-------|----------|
| Hot Plate Digestion | | | | 6/21/2019 | 0 | harleneF |
| Lead | 7439-92-1 | 0.003 mg/L | | 6/26/2019 | 0.003 | BenN |

| Sample | Method | Client Sample Identity | Units | Matrix | Analyst |
|--------------|-------------------|------------------------|-------|----------------|-----------|
| 19060238-014 | EPA 200.5 Rev 4.2 | WF next to Rm 113 | | Drinking Water | CharleneF |

Start Date/Time Sampled: 6/19/2019 8:50:00 AM Composite End Date/Time:

| Parameter | CAS Number | Result | Qualifier | Date/Time Analyzed | RDL | Analyst |
|---------------------|------------|--------------|-----------|--------------------|-------|----------|
| Hot Plate Digestion | | | | 6/21/2019 | 0 | harleneF |
| Lead | 7439-92-1 | < 0.003 mg/L | | 6/26/2019 | 0.003 | BenN |



317 Elm Street
 Milford, NH 03055
 (603) 673-5440
 Sales@chemservelab.com

| Sample | Method | Client Sample Identity | Units | Matrix | Analyst |
|--------------|-------------------|------------------------|-------|----------------|-----------|
| 19060238-015 | EPA 200.5 Rev 4.2 | Rm 111 Sink | | Drinking Water | CharleneF |

Start Date/Time Sampled: 6/19/2019 8:50:00 AM Composite End Date/Time:

| Parameter | CAS Number | Result | Qualifier | Date/Time Analyzed | RDL | Analyst |
|---------------------|------------|------------|-----------|--------------------|-------|----------|
| Hot Plate Digestion | | | | 6/21/2019 | 0 | harleneF |
| Lead | 7439-92-1 | 0.005 mg/L | | 6/26/2019 | 0.003 | BenN |

| Sample | Method | Client Sample Identity | Units | Matrix | Analyst |
|--------------|-------------------|------------------------|-------|----------------|-----------|
| 19060238-016 | EPA 200.5 Rev 4.2 | Rm 107 Sink | | Drinking Water | CharleneF |

Start Date/Time Sampled: 6/19/2019 8:52:00 AM Composite End Date/Time:

| Parameter | CAS Number | Result | Qualifier | Date/Time Analyzed | RDL | Analyst |
|---------------------|------------|------------|-----------|--------------------|-------|----------|
| Hot Plate Digestion | | | | 6/21/2019 | 0 | harleneF |
| Lead | 7439-92-1 | 0.013 mg/L | | 6/26/2019 | 0.003 | BenN |

| Sample | Method | Client Sample Identity | Units | Matrix | Analyst |
|--------------|-------------------|------------------------|-------|----------------|-----------|
| 19060238-017 | EPA 200.5 Rev 4.2 | Rm 105 Sink | | Drinking Water | CharleneF |

Start Date/Time Sampled: 6/19/2019 8:53:00 AM Composite End Date/Time:

| Parameter | CAS Number | Result | Qualifier | Date/Time Analyzed | RDL | Analyst |
|---------------------|------------|------------|-----------|--------------------|-------|----------|
| Hot Plate Digestion | | | | 6/21/2019 | 0 | harleneF |
| Lead | 7439-92-1 | 0.008 mg/L | | 6/26/2019 | 0.003 | BenN |

| Sample | Method | Client Sample Identity | Units | Matrix | Analyst |
|--------------|-------------------|------------------------|-------|----------------|-----------|
| 19060238-018 | EPA 200.5 Rev 4.2 | Rm 104 Sink | | Drinking Water | CharleneF |

Start Date/Time Sampled: 6/19/2019 8:55:00 AM Composite End Date/Time:

| Parameter | CAS Number | Result | Qualifier | Date/Time Analyzed | RDL | Analyst |
|---------------------|------------|------------|-----------|--------------------|-------|----------|
| Hot Plate Digestion | | | | 6/21/2019 | 0 | harleneF |
| Lead | 7439-92-1 | 0.008 mg/L | | 6/26/2019 | 0.003 | BenN |

| Sample | Method | Client Sample Identity | Units | Matrix | Analyst |
|--------------|-------------------|------------------------|-------|----------------|-----------|
| 19060238-019 | EPA 200.5 Rev 4.2 | Rm 106 Sink | | Drinking Water | CharleneF |

Start Date/Time Sampled: 6/19/2019 8:56:00 AM Composite End Date/Time:

| Parameter | CAS Number | Result | Qualifier | Date/Time Analyzed | RDL | Analyst |
|---------------------|------------|------------|-----------|--------------------|-------|----------|
| Hot Plate Digestion | | | | 6/21/2019 | 0 | harleneF |
| Lead | 7439-92-1 | 0.025 mg/L | | 6/26/2019 | 0.003 | BenN |



317 Elm Street
 Milford, NH 03055
 (603) 673-5440
 Sales@chemservelab.com

| Sample | Method | Client Sample Identity | Units | Matrix | Analyst |
|--------------|-------------------|------------------------|-------|----------------|-----------|
| 19060238-020 | EPA 200.5 Rev 4.2 | WF Next to Rm 106 | | Drinking Water | CharleneF |

Start Date/Time Sampled: 6/19/2019 8:53:00 AM Composite End Date/Time:

| Parameter | CAS Number | Result | Qualifier | Date/Time Analyzed | RDL | Analyst |
|---------------------|------------|------------|-----------|--------------------|-------|----------|
| Hot Plate Digestion | | | | 6/21/2019 | 0 | harleneF |
| Lead | 7439-92-1 | 0.003 mg/L | | 6/26/2019 | 0.003 | BenN |

| Sample | Method | Client Sample Identity | Units | Matrix | Analyst |
|--------------|-------------------|------------------------|-------|----------------|-----------|
| 19060238-021 | EPA 200.5 Rev 4.2 | Girls BR lft Sink | | Drinking Water | CharleneF |

Start Date/Time Sampled: 6/19/2019 8:57:00 AM Composite End Date/Time:

| Parameter | CAS Number | Result | Qualifier | Date/Time Analyzed | RDL | Analyst |
|---------------------|------------|------------|-----------|--------------------|-------|----------|
| Hot Plate Digestion | | | | 6/21/2019 | 0 | harleneF |
| Lead | 7439-92-1 | 0.004 mg/L | | 6/26/2019 | 0.003 | BenN |

| Sample | Method | Client Sample Identity | Units | Matrix | Analyst |
|--------------|-------------------|------------------------|-------|----------------|-----------|
| 19060238-022 | EPA 200.5 Rev 4.2 | Girls BR rgt Sink | | Drinking Water | CharleneF |

Start Date/Time Sampled: 6/19/2019 8:58:00 AM Composite End Date/Time:

| Parameter | CAS Number | Result | Qualifier | Date/Time Analyzed | RDL | Analyst |
|---------------------|------------|------------|-----------|--------------------|-------|----------|
| Hot Plate Digestion | | | | 6/21/2019 | 0 | harleneF |
| Lead | 7439-92-1 | 0.004 mg/L | | 6/26/2019 | 0.003 | BenN |

| Sample | Method | Client Sample Identity | Units | Matrix | Analyst |
|--------------|-------------------|------------------------|-------|----------------|-----------|
| 19060238-023 | EPA 200.5 Rev 4.2 | Boys BR rgt Sink | | Drinking Water | CharleneF |

Start Date/Time Sampled: 6/19/2019 9:07:00 AM Composite End Date/Time:

| Parameter | CAS Number | Result | Qualifier | Date/Time Analyzed | RDL | Analyst |
|---------------------|------------|------------|-----------|--------------------|-------|----------|
| Hot Plate Digestion | | | | 6/21/2019 | 0 | harleneF |
| Lead | 7439-92-1 | 0.015 mg/L | | 6/26/2019 | 0.003 | BenN |

| Sample | Method | Client Sample Identity | Units | Matrix | Analyst |
|--------------|-------------------|------------------------|-------|----------------|-----------|
| 19060238-024 | EPA 200.5 Rev 4.2 | Boys BR lft Sink | | Drinking Water | CharleneF |

Start Date/Time Sampled: 6/19/2019 9:06:00 AM Composite End Date/Time:

| Parameter | CAS Number | Result | Qualifier | Date/Time Analyzed | RDL | Analyst |
|---------------------|------------|------------|-----------|--------------------|-------|----------|
| Hot Plate Digestion | | | | 6/21/2019 | 0 | harleneF |
| Lead | 7439-92-1 | 0.014 mg/L | | 6/26/2019 | 0.003 | BenN |



317 Elm Street
 Milford, NH 03055
 (603) 673-5440
 Sales@chemservelab.com

| Sample | Method | Client Sample Identity | Units | Matrix | Analyst |
|--------------|-------------------|------------------------|-------|----------------|-----------|
| 19060238-025 | EPA 200.5 Rev 4.2 | Rm 201 SW sink | | Drinking Water | CharleneF |

Start Date/Time Sampled: 6/19/2019 9:09:00 AM Composite End Date/Time:

| Parameter | CAS Number | Result | Qualifier | Date/Time Analyzed | RDL | Analyst |
|---------------------|------------|------------|-----------|--------------------|-------|----------|
| Hot Plate Digestion | | | | 6/21/2019 | 0 | harleneF |
| Lead | 7439-92-1 | 0.005 mg/L | | 6/26/2019 | 0.003 | BenN |

| Sample | Method | Client Sample Identity | Units | Matrix | Analyst |
|--------------|-------------------|------------------------|-------|----------------|-----------|
| 19060238-026 | EPA 200.5 Rev 4.2 | Rm 201 SE sink | | Drinking Water | CharleneF |

Start Date/Time Sampled: 6/19/2019 9:10:00 AM Composite End Date/Time:

| Parameter | CAS Number | Result | Qualifier | Date/Time Analyzed | RDL | Analyst |
|---------------------|------------|------------|-----------|--------------------|-------|----------|
| Hot Plate Digestion | | | | 6/21/2019 | 0 | harleneF |
| Lead | 7439-92-1 | 0.003 mg/L | | 6/26/2019 | 0.003 | BenN |

| Sample | Method | Client Sample Identity | Units | Matrix | Analyst |
|--------------|-------------------|------------------------|-------|----------------|-----------|
| 19060238-027 | EPA 200.5 Rev 4.2 | Rm 201 NW sink | | Drinking Water | CharleneF |

Start Date/Time Sampled: 6/19/2019 9:11:00 AM Composite End Date/Time:

| Parameter | CAS Number | Result | Qualifier | Date/Time Analyzed | RDL | Analyst |
|---------------------|------------|--------------|-----------|--------------------|-------|----------|
| Hot Plate Digestion | | | | 6/21/2019 | 0 | harleneF |
| Lead | 7439-92-1 | < 0.003 mg/L | | 6/26/2019 | 0.003 | BenN |

| Sample | Method | Client Sample Identity | Units | Matrix | Analyst |
|--------------|-------------------|------------------------|-------|----------------|-----------|
| 19060238-028 | EPA 200.5 Rev 4.2 | Rm 201 NE sink | | Drinking Water | CharleneF |

Start Date/Time Sampled: 6/19/2019 9:12:00 AM Composite End Date/Time:

| Parameter | CAS Number | Result | Qualifier | Date/Time Analyzed | RDL | Analyst |
|---------------------|------------|------------|-----------|--------------------|-------|----------|
| Hot Plate Digestion | | | | 6/21/2019 | 0 | harleneF |
| Lead | 7439-92-1 | 0.004 mg/L | | 6/26/2019 | 0.003 | BenN |

| Sample | Method | Client Sample Identity | Units | Matrix | Analyst |
|--------------|-------------------|------------------------|-------|----------------|-----------|
| 19060238-029 | EPA 200.5 Rev 4.2 | Rm 201 Center sink | | Drinking Water | CharleneF |

Start Date/Time Sampled: 6/19/2019 9:13:00 AM Composite End Date/Time:

| Parameter | CAS Number | Result | Qualifier | Date/Time Analyzed | RDL | Analyst |
|---------------------|------------|------------|-----------|--------------------|-------|----------|
| Hot Plate Digestion | | | | 6/21/2019 | 0 | harleneF |
| Lead | 7439-92-1 | 0.005 mg/L | | 6/26/2019 | 0.003 | BenN |



317 Elm Street
 Milford, NH 03055
 (603) 673-5440
 Sales@chemservelab.com

| Sample | Method | Client Sample Identity | Units | Matrix | Analyst |
|--------------|-------------------|------------------------|-------|----------------|-----------|
| 19060238-030 | EPA 200.5 Rev 4.2 | Library Office Sink | | Drinking Water | CharleneF |

Start Date/Time Sampled: 6/19/2019 9:15:00 AM Composite End Date/Time:

| Parameter | CAS Number | Result | Qualifier | Date/Time Analyzed | RDL | Analyst |
|---------------------|------------|------------|-----------|--------------------|-------|----------|
| Hot Plate Digestion | | | | 6/21/2019 | 0 | harleneF |
| Lead | 7439-92-1 | 0.011 mg/L | | 6/26/2019 | 0.003 | BenN |

| Sample | Method | Client Sample Identity | Units | Matrix | Analyst |
|--------------|-------------------|------------------------|-------|----------------|-----------|
| 19060238-031 | EPA 200.5 Rev 4.2 | SE Sink | | Drinking Water | CharleneF |

Start Date/Time Sampled: 6/19/2019 9:17:00 AM Composite End Date/Time:

| Parameter | CAS Number | Result | Qualifier | Date/Time Analyzed | RDL | Analyst |
|---------------------|------------|--------------|-----------|--------------------|-------|----------|
| Hot Plate Digestion | | | | 6/21/2019 | 0 | harleneF |
| Lead | 7439-92-1 | < 0.003 mg/L | | 6/26/2019 | 0.003 | BenN |

| Sample | Method | Client Sample Identity | Units | Matrix | Analyst |
|--------------|-------------------|------------------------|-------|----------------|-----------|
| 19060238-032 | EPA 200.5 Rev 4.2 | SW Sink | | Drinking Water | CharleneF |

Start Date/Time Sampled: 6/19/2019 9:17:00 AM Composite End Date/Time:

| Parameter | CAS Number | Result | Qualifier | Date/Time Analyzed | RDL | Analyst |
|---------------------|------------|------------|-----------|--------------------|-------|----------|
| Hot Plate Digestion | | | | 6/21/2019 | 0 | harleneF |
| Lead | 7439-92-1 | 0.005 mg/L | | 6/26/2019 | 0.003 | BenN |

| Sample | Method | Client Sample Identity | Units | Matrix | Analyst |
|--------------|-------------------|------------------------|-------|----------------|-----------|
| 19060238-033 | EPA 200.5 Rev 4.2 | NW Sink | | Drinking Water | CharleneF |

Start Date/Time Sampled: 6/19/2019 9:18:00 AM Composite End Date/Time:

| Parameter | CAS Number | Result | Qualifier | Date/Time Analyzed | RDL | Analyst |
|---------------------|------------|------------|-----------|--------------------|-------|----------|
| Hot Plate Digestion | | | | 6/21/2019 | 0 | harleneF |
| Lead | 7439-92-1 | 0.006 mg/L | | 6/26/2019 | 0.003 | BenN |

| Sample | Method | Client Sample Identity | Units | Matrix | Analyst |
|--------------|-------------------|------------------------|-------|----------------|-----------|
| 19060238-034 | EPA 200.5 Rev 4.2 | NE Sink | | Drinking Water | CharleneF |

Start Date/Time Sampled: 6/19/2019 9:19:00 AM Composite End Date/Time:

| Parameter | CAS Number | Result | Qualifier | Date/Time Analyzed | RDL | Analyst |
|---------------------|------------|------------|-----------|--------------------|-------|----------|
| Hot Plate Digestion | | | | 6/21/2019 | 0 | harleneF |
| Lead | 7439-92-1 | 0.095 mg/L | | 6/26/2019 | 0.003 | BenN |



317 Elm Street
 Milford, NH 03055
 (603) 673-5440
 Sales@chemservelab.com

| Sample | Method | Client Sample Identity | Units | Matrix | Analyst |
|--------------|-------------------|------------------------|-------|----------------|-----------|
| 19060238-035 | EPA 200.5 Rev 4.2 | Rm 213 Sink | | Drinking Water | CharleneF |

Start Date/Time Sampled: 6/19/2019 9:22:00 AM Composite End Date/Time:

| Parameter | CAS Number | Result | Qualifier | Date/Time Analyzed | RDL | Analyst |
|---------------------|------------|------------|-----------|--------------------|-------|----------|
| Hot Plate Digestion | | | | 6/21/2019 | 0 | harleneF |
| Lead | 7439-92-1 | 0.006 mg/L | | 6/26/2019 | 0.003 | BenN |

| Sample | Method | Client Sample Identity | Units | Matrix | Analyst |
|--------------|-------------------|------------------------|-------|----------------|-----------|
| 19060238-036 | EPA 200.5 Rev 4.2 | Rm 213 BR Sink | | Drinking Water | CharleneF |

Start Date/Time Sampled: 6/19/2019 9:22:00 AM Composite End Date/Time:

| Parameter | CAS Number | Result | Qualifier | Date/Time Analyzed | RDL | Analyst |
|---------------------|------------|--------------|-----------|--------------------|-------|----------|
| Hot Plate Digestion | | | | 6/21/2019 | 0 | harleneF |
| Lead | 7439-92-1 | < 0.003 mg/L | | 6/26/2019 | 0.003 | BenN |

| Sample | Method | Client Sample Identity | Units | Matrix | Analyst |
|--------------|-------------------|------------------------|-------|----------------|-----------|
| 19060238-037 | EPA 200.5 Rev 4.2 | 7/8 Grade wash Basin | | Drinking Water | CharleneF |

Start Date/Time Sampled: 6/19/2019 9:24:00 AM Composite End Date/Time:

| Parameter | CAS Number | Result | Qualifier | Date/Time Analyzed | RDL | Analyst |
|---------------------|------------|--------------|-----------|--------------------|-------|----------|
| Hot Plate Digestion | | | | 6/21/2019 | 0 | harleneF |
| Lead | 7439-92-1 | < 0.003 mg/L | | 6/26/2019 | 0.003 | BenN |

| Sample | Method | Client Sample Identity | Units | Matrix | Analyst |
|--------------|-------------------|------------------------|-------|----------------|-----------|
| 19060238-038 | EPA 200.5 Rev 4.2 | Staff Rm BR Sink | | Drinking Water | CharleneF |

Start Date/Time Sampled: 6/19/2019 9:26:00 AM Composite End Date/Time:

| Parameter | CAS Number | Result | Qualifier | Date/Time Analyzed | RDL | Analyst |
|---------------------|------------|------------|-----------|--------------------|-------|----------|
| Hot Plate Digestion | | | | 6/21/2019 | 0 | harleneF |
| Lead | 7439-92-1 | 0.003 mg/L | | 6/26/2019 | 0.003 | BenN |

| Sample | Method | Client Sample Identity | Units | Matrix | Analyst |
|--------------|-------------------|------------------------|-------|----------------|-----------|
| 19060238-039 | EPA 200.5 Rev 4.2 | Staff Rm Sink | | Drinking Water | CharleneF |

Start Date/Time Sampled: 6/19/2019 9:28:00 AM Composite End Date/Time:

| Parameter | CAS Number | Result | Qualifier | Date/Time Analyzed | RDL | Analyst |
|---------------------|------------|------------|-----------|--------------------|-------|----------|
| Hot Plate Digestion | | | | 6/21/2019 | 0 | harleneF |
| Lead | 7439-92-1 | 0.015 mg/L | | 6/26/2019 | 0.003 | BenN |



317 Elm Street
 Milford, NH 03055
 (603) 673-5440
 Sales@chemservelab.com

| Sample | Method | Client Sample Identity | Units | Matrix | Analyst |
|--------------|-------------------|------------------------|-------|----------------|-----------|
| 19060238-040 | EPA 200.5 Rev 4.2 | WF near Rm 301 | | Drinking Water | CharleneF |

Start Date/Time Sampled: 6/19/2019 9:03:00 AM Composite End Date/Time:

| Parameter | CAS Number | Result | Qualifier | Date/Time Analyzed | RDL | Analyst |
|---------------------|------------|--------------|-----------|--------------------|-------|----------|
| Hot Plate Digestion | | | | 6/21/2019 | 0 | harleneF |
| Lead | 7439-92-1 | < 0.003 mg/L | | 6/26/2019 | 0.003 | BenN |

| Sample | Method | Client Sample Identity | Units | Matrix | Analyst |
|--------------|-------------------|------------------------|-------|----------------|-----------|
| 19060238-041 | EPA 200.5 Rev 4.2 | Rm 301 SW Sink | | Drinking Water | CharleneF |

Start Date/Time Sampled: 6/19/2019 9:31:00 AM Composite End Date/Time:

| Parameter | CAS Number | Result | Qualifier | Date/Time Analyzed | RDL | Analyst |
|---------------------|------------|------------|-----------|--------------------|-------|----------|
| Hot Plate Digestion | | | | 6/21/2019 | 0 | harleneF |
| Lead | 7439-92-1 | 0.012 mg/L | | 6/26/2019 | 0.003 | BenN |

| Sample | Method | Client Sample Identity | Units | Matrix | Analyst |
|--------------|-------------------|------------------------|-------|----------------|-----------|
| 19060238-042 | EPA 200.5 Rev 4.2 | Rm 301 SE Sink | | Drinking Water | CharleneF |

Start Date/Time Sampled: 6/19/2019 9:33:00 AM Composite End Date/Time:

| Parameter | CAS Number | Result | Qualifier | Date/Time Analyzed | RDL | Analyst |
|---------------------|------------|------------|-----------|--------------------|-------|----------|
| Hot Plate Digestion | | | | 6/21/2019 | 0 | harleneF |
| Lead | 7439-92-1 | 0.004 mg/L | | 6/26/2019 | 0.003 | BenN |

| Sample | Method | Client Sample Identity | Units | Matrix | Analyst |
|--------------|-------------------|------------------------|-------|----------------|-----------|
| 19060238-043 | EPA 200.5 Rev 4.2 | Rm 301 NE Sink | | Drinking Water | CharleneF |

Start Date/Time Sampled: 6/19/2019 9:34:00 AM Composite End Date/Time:

| Parameter | CAS Number | Result | Qualifier | Date/Time Analyzed | RDL | Analyst |
|---------------------|------------|------------|-----------|--------------------|-------|----------|
| Hot Plate Digestion | | | | 6/21/2019 | 0 | harleneF |
| Lead | 7439-92-1 | 0.016 mg/L | | 6/26/2019 | 0.003 | BenN |

| Sample | Method | Client Sample Identity | Units | Matrix | Analyst |
|--------------|-------------------|------------------------|-------|----------------|-----------|
| 19060238-044 | EPA 200.5 Rev 4.2 | Rm 301 NW Sink | | Drinking Water | CharleneF |

Start Date/Time Sampled: 6/19/2019 9:35:00 AM Composite End Date/Time:

| Parameter | CAS Number | Result | Qualifier | Date/Time Analyzed | RDL | Analyst |
|---------------------|------------|-----------|-----------|--------------------|-------|----------|
| Hot Plate Digestion | | | | 6/21/2019 | 0 | harleneF |
| Lead | 7439-92-1 | 2.77 mg/L | | 6/26/2019 | 0.003 | BenN |



317 Elm Street
 Milford, NH 03055
 (603) 673-5440
 Sales@chemservelab.com

| Sample | Method | Client Sample Identity | Units | Matrix | Analyst |
|--------------|-------------------|------------------------|-------|----------------|-----------|
| 19060238-045 | EPA 200.5 Rev 4.2 | Rm 301 Center Sink | | Drinking Water | CharleneF |

Start Date/Time Sampled: 6/19/2019 9:34:00 AM Composite End Date/Time:

| Parameter | CAS Number | Result | Qualifier | Date/Time Analyzed | RDL | Analyst |
|---------------------|------------|------------|-----------|--------------------|-------|----------|
| Hot Plate Digestion | | | | 6/21/2019 | 0 | harleneF |
| Lead | 7439-92-1 | 0.673 mg/L | | 6/26/2019 | 0.003 | BenN |

| Sample | Method | Client Sample Identity | Units | Matrix | Analyst |
|--------------|-------------------|------------------------|-------|----------------|-----------|
| 19060238-046 | EPA 200.5 Rev 4.2 | Rm 215 lft Sink | | Drinking Water | CharleneF |

Start Date/Time Sampled: 6/19/2019 9:44:00 AM Composite End Date/Time:

| Parameter | CAS Number | Result | Qualifier | Date/Time Analyzed | RDL | Analyst |
|---------------------|------------|------------|-----------|--------------------|-------|----------|
| Hot Plate Digestion | | | | 6/21/2019 | 0 | harleneF |
| Lead | 7439-92-1 | 0.028 mg/L | | 6/26/2019 | 0.003 | BenN |

| Sample | Method | Client Sample Identity | Units | Matrix | Analyst |
|--------------|-------------------|------------------------|-------|----------------|-----------|
| 19060238-047 | EPA 200.5 Rev 4.2 | Rm 215 rgt Sink | | Drinking Water | CharleneF |

Start Date/Time Sampled: 6/19/2019 9:45:00 AM Composite End Date/Time:

| Parameter | CAS Number | Result | Qualifier | Date/Time Analyzed | RDL | Analyst |
|---------------------|------------|------------|-----------|--------------------|-------|----------|
| Hot Plate Digestion | | | | 6/21/2019 | 0 | harleneF |
| Lead | 7439-92-1 | 0.022 mg/L | | 6/26/2019 | 0.003 | BenN |

| Sample | Method | Client Sample Identity | Units | Matrix | Analyst |
|--------------|-------------------|------------------------|-------|----------------|-----------|
| 19060238-048 | EPA 200.5 Rev 4.2 | Rm 303 SW Sink | | Drinking Water | CharleneF |

Start Date/Time Sampled: 6/19/2019 9:40:00 AM Composite End Date/Time:

| Parameter | CAS Number | Result | Qualifier | Date/Time Analyzed | RDL | Analyst |
|---------------------|------------|------------|-----------|--------------------|-------|----------|
| Hot Plate Digestion | | | | 6/21/2019 | 0 | harleneF |
| Lead | 7439-92-1 | 0.008 mg/L | | 6/26/2019 | 0.003 | BenN |

| Sample | Method | Client Sample Identity | Units | Matrix | Analyst |
|--------------|-------------------|------------------------|-------|----------------|-----------|
| 19060238-049 | EPA 200.5 Rev 4.2 | Rm 303 SE Sink | | Drinking Water | CharleneF |

Start Date/Time Sampled: 6/19/2019 9:41:00 AM Composite End Date/Time:

| Parameter | CAS Number | Result | Qualifier | Date/Time Analyzed | RDL | Analyst |
|---------------------|------------|------------|-----------|--------------------|-------|----------|
| Hot Plate Digestion | | | | 6/21/2019 | 0 | harleneF |
| Lead | 7439-92-1 | 0.010 mg/L | | 6/26/2019 | 0.003 | BenN |

| Sample | Method | Client Sample Identity | Units | Matrix | Analyst |
|--------------|-------------------|------------------------|-------|----------------|-----------|
| 19060238-050 | EPA 200.5 Rev 4.2 | Rm 303 NW Sink | | Drinking Water | CharleneF |

Start Date/Time Sampled: 6/19/2019 9:40:00 AM Composite End Date/Time:

| Parameter | CAS Number | Result | Qualifier | Date/Time Analyzed | RDL | Analyst |
|---------------------|------------|------------|-----------|--------------------|-------|----------|
| Hot Plate Digestion | | | | 6/21/2019 | 0 | harleneF |
| Lead | 7439-92-1 | 0.004 mg/L | | 6/26/2019 | 0.003 | BenN |

| Sample | Method | Client Sample Identity | Units | Matrix | Analyst |
|--------------|-------------------|------------------------|-------|----------------|-----------|
| 19060238-051 | EPA 200.5 Rev 4.2 | Rm 303 NE Sink | | Drinking Water | CharleneF |

Start Date/Time Sampled: 6/19/2019 9:41:00 AM Composite End Date/Time:

| Parameter | CAS Number | Result | Qualifier | Date/Time Analyzed | RDL | Analyst |
|---------------------|------------|------------|-----------|--------------------|-------|----------|
| Hot Plate Digestion | | | | 6/21/2019 | 0 | harleneF |
| Lead | 7439-92-1 | 0.016 mg/L | | 6/26/2019 | 0.003 | BenN |

| Sample | Method | Client Sample Identity | Units | Matrix | Analyst |
|--------------|-------------------|------------------------|-------|----------------|-----------|
| 19060238-052 | EPA 200.5 Rev 4.2 | Rm 303 Center Sink | | Drinking Water | CharleneF |

Start Date/Time Sampled: 6/19/2019 9:38:00 AM Composite End Date/Time:

| Parameter | CAS Number | Result | Qualifier | Date/Time Analyzed | RDL | Analyst |
|---------------------|------------|-----------|-----------|--------------------|-------|----------|
| Hot Plate Digestion | | | | 6/21/2019 | 0 | harleneF |
| Lead | 7439-92-1 | 3.15 mg/L | | 6/26/2019 | 0.003 | BenN |

| Sample | Method | Client Sample Identity | Units | Matrix | Analyst |
|--------------|-------------------|-----------------------------|-------|----------------|-----------|
| 19060238-053 | EPA 200.5 Rev 4.2 | Rm 220 Bys lcker Rm BR Sink | | Drinking Water | CharleneF |

Start Date/Time Sampled: 6/19/2019 9:41:00 AM Composite End Date/Time:

| Parameter | CAS Number | Result | Qualifier | Date/Time Analyzed | RDL | Analyst |
|---------------------|------------|------------|-----------|--------------------|-------|----------|
| Hot Plate Digestion | | | | 6/21/2019 | 0 | harleneF |
| Lead | 7439-92-1 | 0.006 mg/L | | 6/26/2019 | 0.003 | BenN |

| Sample | Method | Client Sample Identity | Units | Matrix | Analyst |
|--------------|-------------------|------------------------------|-------|----------------|-----------|
| 19060238-054 | EPA 200.5 Rev 4.2 | Rm 221 Grls lcker Rm BR Sink | | Drinking Water | CharleneF |

Start Date/Time Sampled: 6/19/2019 9:50:00 AM Composite End Date/Time:

| Parameter | CAS Number | Result | Qualifier | Date/Time Analyzed | RDL | Analyst |
|---------------------|------------|------------|-----------|--------------------|-------|----------|
| Hot Plate Digestion | | | | 6/21/2019 | 0 | harleneF |
| Lead | 7439-92-1 | 0.010 mg/L | | 6/26/2019 | 0.003 | BenN |



317 Elm Street
 Milford, NH 03055
 (603) 673-5440
 Sales@chemservelab.com

| Sample | Method | Client Sample Identity | Units | Matrix | Analyst |
|--------------|-------------------|------------------------|-------|----------------|-----------|
| 19060238-055 | EPA 200.5 Rev 4.2 | Rm 308 Sink | | Drinking Water | CharleneF |

Start Date/Time Sampled: 6/19/2019 9:53:00 AM Composite End Date/Time:

| Parameter | CAS Number | Result | Qualifier | Date/Time Analyzed | RDL | Analyst |
|---------------------|------------|------------|-----------|--------------------|-------|----------|
| Hot Plate Digestion | | | | 6/21/2019 | 0 | harleneF |
| Lead | 7439-92-1 | 0.010 mg/L | | 6/26/2019 | 0.003 | BenN |

| Sample | Method | Client Sample Identity | Units | Matrix | Analyst |
|--------------|-------------------|------------------------|-------|----------------|-----------|
| 19060238-056 | EPA 200.5 Rev 4.2 | WF Near Rm 308 | | Drinking Water | CharleneF |

Start Date/Time Sampled: 6/19/2019 9:54:00 AM Composite End Date/Time:

| Parameter | CAS Number | Result | Qualifier | Date/Time Analyzed | RDL | Analyst |
|---------------------|------------|--------------|-----------|--------------------|-------|----------|
| Hot Plate Digestion | | | | 6/21/2019 | 0 | harleneF |
| Lead | 7439-92-1 | < 0.003 mg/L | | 6/26/2019 | 0.003 | BenN |

| Sample | Method | Client Sample Identity | Units | Matrix | Analyst |
|--------------|-------------------|------------------------|-------|----------------|-----------|
| 19060238-057 | EPA 200.5 Rev 4.2 | Rm 310 South Sink | | Drinking Water | CharleneF |

Start Date/Time Sampled: 6/19/2019 9:56:00 AM Composite End Date/Time:

| Parameter | CAS Number | Result | Qualifier | Date/Time Analyzed | RDL | Analyst |
|---------------------|------------|--------------|-----------|--------------------|-------|----------|
| Hot Plate Digestion | | | | 6/21/2019 | 0 | harleneF |
| Lead | 7439-92-1 | < 0.003 mg/L | | 6/26/2019 | 0.003 | BenN |

| Sample | Method | Client Sample Identity | Units | Matrix | Analyst |
|--------------|-------------------|------------------------|-------|----------------|-----------|
| 19060238-058 | EPA 200.5 Rev 4.2 | Rm 310 North Sink | | Drinking Water | CharleneF |

Start Date/Time Sampled: 6/19/2019 9:56:00 AM Composite End Date/Time:

| Parameter | CAS Number | Result | Qualifier | Date/Time Analyzed | RDL | Analyst |
|---------------------|------------|--------------|-----------|--------------------|-------|----------|
| Hot Plate Digestion | | | | 6/21/2019 | 0 | harleneF |
| Lead | 7439-92-1 | < 0.003 mg/L | | 6/26/2019 | 0.003 | BenN |

| Sample | Method | Client Sample Identity | Units | Matrix | Analyst |
|--------------|-------------------|------------------------|-------|----------------|-----------|
| 19060238-059 | EPA 200.5 Rev 4.2 | Staff Rm Sink RT | | Drinking Water | CharleneF |

Start Date/Time Sampled: 6/19/2019 9:28:00 AM Composite End Date/Time:

| Parameter | CAS Number | Result | Qualifier | Date/Time Analyzed | RDL | Analyst |
|---------------------|------------|------------|-----------|--------------------|-------|----------|
| Hot Plate Digestion | | | | 6/21/2019 | 0 | harleneF |
| Lead | 7439-92-1 | 0.009 mg/L | | 6/26/2019 | 0.003 | BenN |

Qualifier: Description:

| | |
|-----|--|
| B- | Method blank contaminated with target analyte. |
| B1- | BOD had total oxygen loss. Result reported as ">" the highest dilution. |
| B2- | BOD had no oxygen loss. Result reported as "<" the lowest dilution. |
| G- | Reporting limit elevated due to matrix interference. |
| H- | Method prescribed holding time exceeded. |
| J- | Indicates an estimated value. Value is less than the quantitation limit. |
| IL- | Internal Standard(s) recovery was low due to matrix. Result may be biased high. |
| IH- | Internal Standard(s) recovery was high due to matrix. Result may be biased low. |
| LH- | Laboratory control spike(s) was high. Results may be biased high. |
| LL- | Laboratory control spike(s) was low. Results may be biased low. |
| MH- | Matrix spike recovery high due to matrix. Results may be biased high. |
| ML- | Matrix spike recovery low due to matrix. Results may be biased low. |
| N- | Non-target compound. Reported as a TIC. |
| NC- | Spike recovery was not calculated due to the concentration of the analyte being >4 times the concentration of the spike added. |
| R- | RPD outside acceptable recovery limits. |
| RO- | Sample received out of holding time. |
| SH- | Surrogate recovery high due to matrix |
| SL- | Surrogate recovery low due to matrix |
| U- | BOD/CBOD blank had an oxygen depletion greater than the suggested amount of 0.200. |
| V- | Sample pH for analysis was not within the required range when checked at time of analysis. |
| Z- | Too numerous to count (TNTC) |

An "A" in the result column on the report indicates absent for presence/absent bacteria and a "P" indicates present for presence/absent bacteria.

Customer Name: Concord Valley School District
 School No.: 5, Green Brook Middle School
 19660238-041
 7.3.19
 19060238

| Monitoring Location Identifier | Laboratory Sample Identifier | Sample Purpose | Field Activity Start Date | Field Activity Start Time | Sample ID/Volume | Sample Comments | Laboratory Identifier | Method | Test Method Reference | Analysis Mat | First Draw | Substance Name | Sampler Comments |
|--------------------------------|------------------------------|------------------|---------------------------|---------------------------|------------------|------------------------------------|-----------------------|----------------|-----------------------|--------------|------------|----------------|------------------|
| Sch-22210 | 19060238-001 | Sample - Routine | 06/19/19 | 0840 | SE | Girls BR Sink | 1008 | 200.5 or 200.8 | USEPA | WATER | Y | LEAD | |
| Sch-22210 | 19060238-002 | Sample - Routine | | 0859 | SE | Nurses Office Sink | 1008 | 200.5 or 200.8 | USEPA | WATER | Y | LEAD | |
| Sch-22210 | 19060238-003 | Sample - Routine | | 0845 | SE | Hand Wash Basin BRs next to Office | 1008 | 200.5 or 200.8 | USEPA | WATER | Y | LEAD | |
| Sch-22210 | 19060238-004 | Sample - Routine | | 0840 | SE | WF next to Office Gym | 1008 | 200.5 or 200.8 | USEPA | WATER | Y | LEAD | |
| Sch-22210 | 19060238-005 | Sample - Routine | | 0842 | SE | Staff Kitchen Sink | 1008 | 200.5 or 200.8 | USEPA | WATER | Y | LEAD | |
| Sch-22210 | 19060238-006 | Sample - Routine | | 0844 | SE | Staff BR Sink | 1008 | 200.5 or 200.8 | USEPA | WATER | Y | LEAD | |
| Sch-22210 | 19060238-007 | Sample - Routine | | 0844 | SE | Kitchen Rm Sink Next to 3 Bay Sink | 1008 | 200.5 or 200.8 | USEPA | WATER | Y | LEAD | |
| Sch-22210 | 19060238-008 | Sample - Routine | | 0845 | SE | Kitchen 3 Bay BR Sink | 1008 | 200.5 or 200.8 | USEPA | WATER | Y | LEAD | |
| Sch-22210 | 19060238-009 | Sample - Routine | | 0846 | SE | Hand Wash Sink | 1008 | 200.5 or 200.8 | USEPA | WATER | Y | LEAD | |
| Sch-22210 | 19060238-010 | Sample - Routine | | 0859 | SE | Boys BR Sink | 1008 | 200.5 or 200.8 | USEPA | WATER | Y | LEAD | |
| Sch-22210 | 19060238-011 | Sample - Routine | | 0842 | SE | Hand Wash Sink | 1008 | 200.5 or 200.8 | USEPA | WATER | Y | LEAD | |
| Sch-22210 | 19060238-012 | Sample - Routine | | 0847 | SE | Girls BR in Sink | 1008 | 200.5 or 200.8 | USEPA | WATER | Y | LEAD | |
| Sch-22210 | 19060238-013 | Sample - Routine | | 0848 | SE | Girls BR in Sink | 1008 | 200.5 or 200.8 | USEPA | WATER | Y | LEAD | |
| Sch-22210 | 19060238-014 | Sample - Routine | | 0850 | SE | WF next to Rm 113 | 1008 | 200.5 or 200.8 | USEPA | WATER | Y | LEAD | |
| Sch-22210 | 19060238-015 | Sample - Routine | | 0850 | SE | Rm 111 Sink | 1008 | 200.5 or 200.8 | USEPA | WATER | Y | LEAD | |
| Sch-22210 | 19060238-016 | Sample - Routine | | 0852 | SE | Rm 107 Sink | 1008 | 200.5 or 200.8 | USEPA | WATER | Y | LEAD | |
| Sch-22210 | 19060238-017 | Sample - Routine | | 0853 | SE | Rm 105 Sink | 1008 | 200.5 or 200.8 | USEPA | WATER | Y | LEAD | |
| Sch-22210 | 19060238-018 | Sample - Routine | | 0855 | SE | Rm 104 Sink | 1008 | 200.5 or 200.8 | USEPA | WATER | Y | LEAD | |
| Sch-22210 | 19060238-019 | Sample - Routine | | 0856 | SE | WF Next to Rm 106 | 1008 | 200.5 or 200.8 | USEPA | WATER | Y | LEAD | |
| Sch-22210 | 19060238-020 | Sample - Routine | | 0853 | SE | Rm 108 Sink | 1008 | 200.5 or 200.8 | USEPA | WATER | Y | LEAD | |
| Sch-22210 | 19060238-021 | Sample - Routine | | 0857 | SE | Girls BR in Sink | 1008 | 200.5 or 200.8 | USEPA | WATER | Y | LEAD | |
| Sch-22210 | 19060238-022 | Sample - Routine | | 0858 | SE | Girls BR in Sink | 1008 | 200.5 or 200.8 | USEPA | WATER | Y | LEAD | |
| Sch-22210 | 19060238-023 | Sample - Routine | | 0907 | SE | Boys BR in Sink | 1008 | 200.5 or 200.8 | USEPA | WATER | Y | LEAD | |
| Sch-22210 | 19060238-024 | Sample - Routine | | 0906 | SE | Boys BR in Sink | 1008 | 200.5 or 200.8 | USEPA | WATER | Y | LEAD | |
| Sch-22210 | 19060238-025 | Sample - Routine | | 0909 | SE | Rm 201 SW Sink | 1008 | 200.5 or 200.8 | USEPA | WATER | Y | LEAD | |
| Sch-22210 | 19060238-026 | Sample - Routine | | 0910 | SE | Rm 201 SE Sink | 1008 | 200.5 or 200.8 | USEPA | WATER | Y | LEAD | |
| Sch-22210 | 19060238-027 | Sample - Routine | | 0911 | SE | Rm 201 NW Sink | 1008 | 200.5 or 200.8 | USEPA | WATER | Y | LEAD | |
| Sch-22210 | 19060238-028 | Sample - Routine | | 0912 | SE | Rm 201 NE Sink | 1008 | 200.5 or 200.8 | USEPA | WATER | Y | LEAD | |
| Sch-22210 | 19060238-029 | Sample - Routine | | 0913 | SE | Rm 201 Center Sink | 1008 | 200.5 or 200.8 | USEPA | WATER | Y | LEAD | |
| Sch-22210 | 19060238-030 | Sample - Routine | | 0915 | SE | Library Office Sink | 1008 | 200.5 or 200.8 | USEPA | WATER | Y | LEAD | |
| Sch-22210 | 19060238-031 | Sample - Routine | | 0917 | SE | SE Sink | 1008 | 200.5 or 200.8 | USEPA | WATER | Y | LEAD | |
| Sch-22210 | 19060238-032 | Sample - Routine | | 0919 | SE | SW Sink | 1008 | 200.5 or 200.8 | USEPA | WATER | Y | LEAD | |
| Sch-22210 | 19060238-033 | Sample - Routine | | 0918 | SE | NW Sink | 1008 | 200.5 or 200.8 | USEPA | WATER | Y | LEAD | |
| Sch-22210 | 19060238-034 | Sample - Routine | | 0919 | SE | NE Sink | 1008 | 200.5 or 200.8 | USEPA | WATER | Y | LEAD | |
| Sch-22210 | 19060238-035 | Sample - Routine | | 0920 | SE | Rm 213 Sink | 1008 | 200.5 or 200.8 | USEPA | WATER | Y | LEAD | |
| Sch-22210 | 19060238-036 | Sample - Routine | | 0922 | SE | Rm 213 BR Sink | 1008 | 200.5 or 200.8 | USEPA | WATER | Y | LEAD | |
| Sch-22210 | 19060238-037 | Sample - Routine | | 0924 | SE | 7th Grade Wash Basin | 1008 | 200.5 or 200.8 | USEPA | WATER | Y | LEAD | |
| Sch-22210 | 19060238-038 | Sample - Routine | | 0926 | SE | Staff BR BR Sink | 1008 | 200.5 or 200.8 | USEPA | WATER | Y | LEAD | |
| Sch-22210 | 19060238-039 | Sample - Routine | | 0928 | SE | Staff BR Sink | 1008 | 200.5 or 200.8 | USEPA | WATER | Y | LEAD | |
| Sch-22210 | 19060238-040 | Sample - Routine | | 0930 | SE | WF near Rm 301 | 1008 | 200.5 or 200.8 | USEPA | WATER | Y | LEAD | |
| Sch-22210 | 19060238-041 | Sample - Routine | | 0931 | SE | Rm 301 SW Sink | 1008 | 200.5 or 200.8 | USEPA | WATER | Y | LEAD | |

Requested By:  Date/Time: 6/19/19 7:30
 Received By:  Date/Time: 6/19/19 4:30
 S.2C

19060238 7.3.19

| Sch-22210 | 19060238-042 | Sample - Routine | 6/15/19 | 0933 | KC | Rm 301 SE Sink | 1008 | 200.5 or 200.8 | USEPA | WATER | Y | LEAD |
|-----------|--------------|------------------|---------|------|----|--------------------------------|------|----------------|-------|-------|---|------|
| Sch-22210 | 19060238-043 | Sample - Routine | | 0934 | KC | Rm 301 NE Sink | 1008 | 200.5 or 200.8 | USEPA | WATER | Y | LEAD |
| Sch-22210 | 19060238-044 | Sample - Routine | | 0935 | KC | Rm 301 NW Sink | 1008 | 200.5 or 200.8 | USEPA | WATER | Y | LEAD |
| Sch-22210 | 19060238-045 | Sample - Routine | | 0939 | KC | Rm 301 Center Sink | 1008 | 200.5 or 200.8 | USEPA | WATER | Y | LEAD |
| Sch-22210 | 19060238-046 | Sample - Routine | | 0944 | KC | Rm 215 Ill Sink | 1008 | 200.5 or 200.8 | USEPA | WATER | Y | LEAD |
| Sch-22210 | 19060238-047 | Sample - Routine | | 0945 | KC | Rm 215 Hgt Sink | 1008 | 200.5 or 200.8 | USEPA | WATER | Y | LEAD |
| Sch-22210 | 19060238-048 | Sample - Routine | | 0946 | KC | Rm 303 SW Sink | 1008 | 200.5 or 200.8 | USEPA | WATER | Y | LEAD |
| Sch-22210 | 19060238-049 | Sample - Routine | | 0947 | KC | Rm 303 SE Sink | 1008 | 200.5 or 200.8 | USEPA | WATER | Y | LEAD |
| Sch-22210 | 19060238-050 | Sample - Routine | | 0948 | KC | Rm 303 NW Sink | 1008 | 200.5 or 200.8 | USEPA | WATER | Y | LEAD |
| Sch-22210 | 19060238-051 | Sample - Routine | | 0949 | KC | Rm 303 NE Sink | 1008 | 200.5 or 200.8 | USEPA | WATER | Y | LEAD |
| Sch-22210 | 19060238-052 | Sample - Routine | | 0950 | KC | Rm 303 Center Sink | 1008 | 200.5 or 200.8 | USEPA | WATER | Y | LEAD |
| Sch-22210 | 19060238-053 | Sample - Routine | | 0951 | KC | Rm 220 Boys locker Rm BR Sink | 1008 | 200.5 or 200.8 | USEPA | WATER | Y | LEAD |
| Sch-22210 | 19060238-054 | Sample - Routine | | 0952 | KC | Rm 221 Girls locker Rm BR Sink | 1008 | 200.5 or 200.8 | USEPA | WATER | Y | LEAD |
| Sch-22210 | 19060238-055 | Sample - Routine | | 0953 | KC | Rm 306 Sink | 1008 | 200.5 or 200.8 | USEPA | WATER | Y | LEAD |
| Sch-22210 | 19060238-056 | Sample - Routine | | 0954 | KC | WF Near Rm 308 | 1008 | 200.5 or 200.8 | USEPA | WATER | Y | LEAD |
| Sch-22210 | 19060238-057 | Sample - Routine | | 0955 | KC | Rm 310 South Sink | 1008 | 200.5 or 200.8 | USEPA | WATER | Y | LEAD |
| Sch-22210 | 19060238-058 | Sample - Routine | | 0956 | KC | Rm 310 North Sink | 1008 | 200.5 or 200.8 | USEPA | WATER | Y | LEAD |
| Sch-22210 | -059 | Sample - Routine | 6/16/19 | 0958 | KC | SEFF Rm Sink NT | 1008 | 200.5 or 200.8 | USEPA | WATER | Y | LEAD |
| Sch-22210 | | Sample - Routine | | | | | 1008 | 200.5 or 200.8 | USEPA | WATER | Y | LEAD |
| Sch-22210 | | Sample - Routine | | | | | 1008 | 200.5 or 200.8 | USEPA | WATER | Y | LEAD |
| Sch-22210 | | Sample - Routine | | | | | 1008 | 200.5 or 200.8 | USEPA | WATER | Y | LEAD |
| Sch-22210 | | Sample - Routine | | | | | 1008 | 200.5 or 200.8 | USEPA | WATER | Y | LEAD |
| Sch-22210 | | Sample - Routine | | | | | 1008 | 200.5 or 200.8 | USEPA | WATER | Y | LEAD |
| Sch-22210 | | Sample - Routine | | | | | 1008 | 200.5 or 200.8 | USEPA | WATER | Y | LEAD |
| Sch-22210 | | Sample - Routine | | | | | 1008 | 200.5 or 200.8 | USEPA | WATER | Y | LEAD |
| Sch-22210 | | Sample - Routine | | | | | 1008 | 200.5 or 200.8 | USEPA | WATER | Y | LEAD |
| Sch-22210 | | Sample - Routine | | | | | 1008 | 200.5 or 200.8 | USEPA | WATER | Y | LEAD |
| Sch-22210 | | Sample - Routine | | | | | 1008 | 200.5 or 200.8 | USEPA | WATER | Y | LEAD |
| Sch-22210 | | Sample - Routine | | | | | 1008 | 200.5 or 200.8 | USEPA | WATER | Y | LEAD |
| Sch-22210 | | Sample - Routine | | | | | 1008 | 200.5 or 200.8 | USEPA | WATER | Y | LEAD |
| Sch-22210 | | Sample - Routine | | | | | 1008 | 200.5 or 200.8 | USEPA | WATER | Y | LEAD |
| Sch-22210 | | Sample - Routine | | | | | 1008 | 200.5 or 200.8 | USEPA | WATER | Y | LEAD |

Requisitioned By: _____ Date/Time: _____ Received By: _____ Date/Time: _____

D - Fountains
X - Sinks

Great Brook Middle School Main Floor

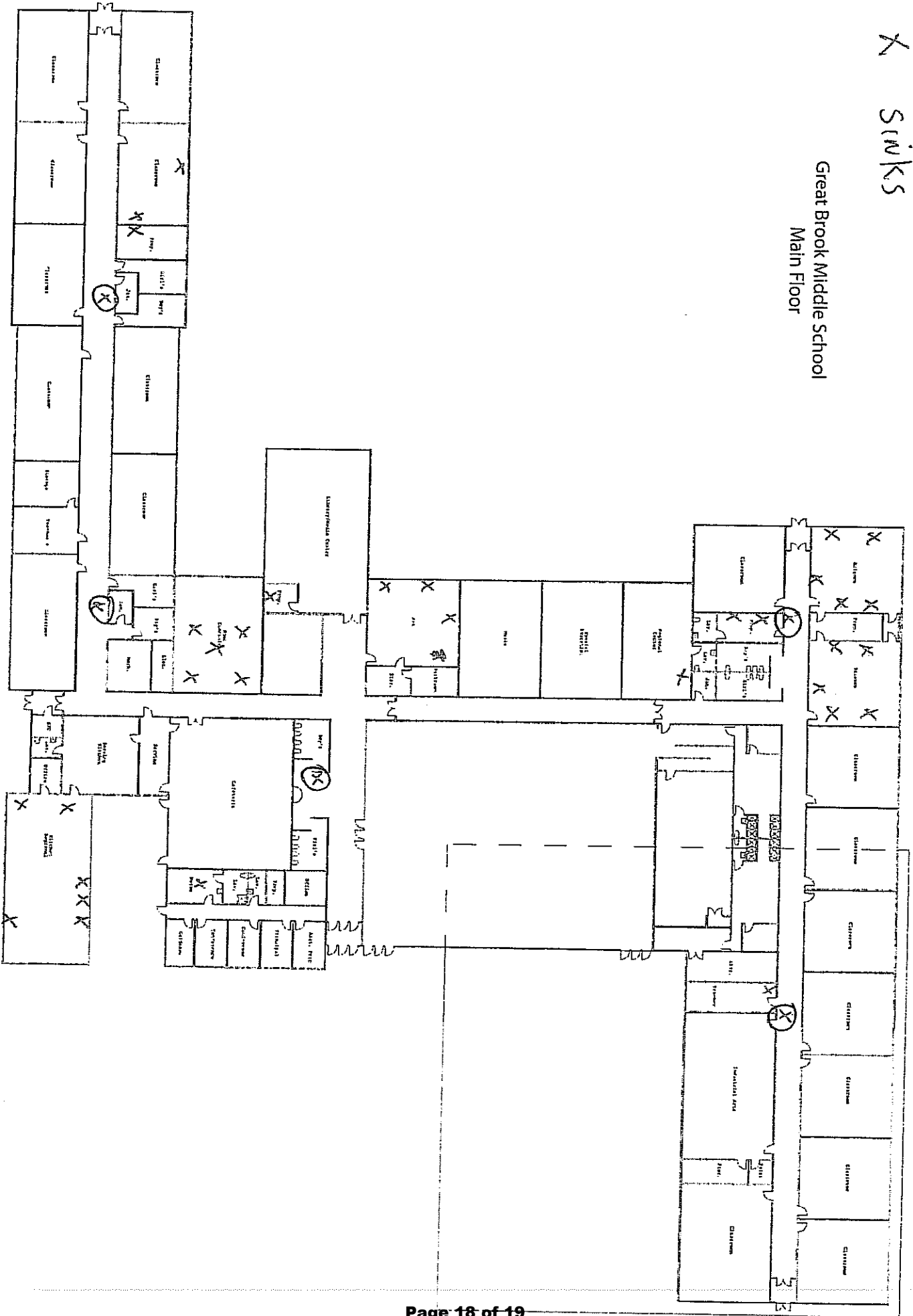

19060238

0 - Fountains
X Sinks

Great Brook Middle School
Main Floor

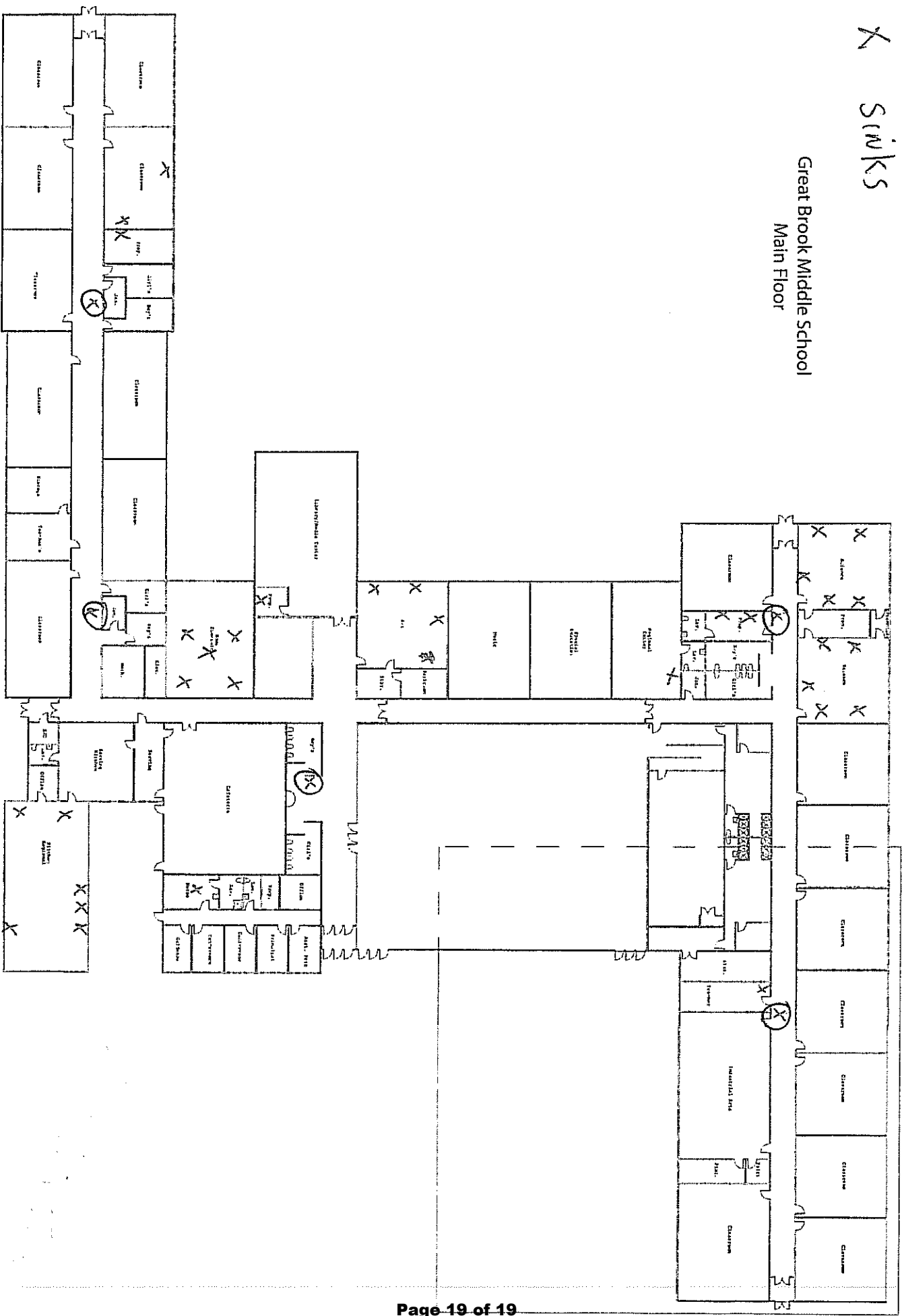

19660238