

Wednesday, July 24, 2019

Tim Grossi
Contoocook Valley School District
106 Hancock Road
Peterborough NH 03458

Project Name: Peterborough Elementary School

Lab ID: 19060241

Project #: N/A

Date Received: 6/25/2019

Project Location: SCH-22310

Control #: 19060241

Dear Tim Grossi

Enclosed please find the laboratory results for the above referenced samples that were received by the ChemServe sample custodian on the above referenced date. Any abnormalities to the samples upon receipt would be noted on the enclosed chain of custody document. This report is not valid without a completed chain of custody with the corresponding control number, attached.

All samples analyzed by ChemServe are subject to quality standards. These standards are as stringent or more stringent than those established under NELAC, 40 CFR Part 136, state certification programs, and corresponding methodologies. ChemServe has a written QA/QC Procedures Manual that outlines these standards, and is available for your reference, upon request. Unless otherwise stated on the Chain of Custody or within the report, all holding times, preservation techniques, container types, and analytical methods are analogous with those outlined by NELAC. All units are based on "as received" weight unless denoted "dry".

Residual chlorine, sulfite and pH are intended to be performed as an immediate field analysis. Should any of these analyses be performed in the lab instead of in the field it will result in those analyses being performed out of holding time.

Acrolein and 2-chloroethylvinyl ether require an additional analysis with an un-preserved sample. If unpreserved vials were not submitted for these additional analysis then acrolein and 2-CEVE are reported as estimated due to not meeting method requirements for EPA 624.1 or EPA 524.2.

I certify that I have reviewed the above referenced analytical data and state forms, and I have found this report within compliance with the procedures outlined within NELAC. ChemServe's certified parameter list can be found at <http://www.chemservelab.com/Laboratory-Information-and-Documentation.aspx>

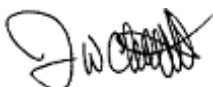

Jay Chrystal - President/Laboratory Director



Contoocook Valley School District
 Tim Grossi
 106 Hancock Road
 Peterborough NH 03458

Control #: 19060241
 Project Number: N/A
 Project Name: Peterborough Elementary School
 Project Location: SCH-22310

Lab ID: 19060241
 Date: 7/24/2019

Lab ID: 19060241

Sample Receiving and Comment Summary

Were samples submitted with a chain of custody?	Yes
Do all samples received match the chain of custody?	Yes
Were all samples received within applicable holding times?	Yes
Were all containers intact when received?	Yes
Were samples for volatile organic analysis free of headspace (per method)?	N/A
Was there evidence of cooling if not submitted the same day as sampling?	Yes
If the sample pH was not correct was it adjusted where applicable?	Yes
Were samples for dissolved metals already filtered by the client or field sampling?	N/A
Were Samples for O-phos filtered in the field?	N/A
Were samples received in the appropriate containers?	Yes
Where applicable; were chemical and micro samples received at correct temps.	N/A

Sample	Method	Client Identity	Matrix	Analyst
19060241-001	EPA 200.5 Rev 4.2	Nurses Office Sink	Drinking Water	CharleneF

Comment: no comment

* Blank comment sections denote "No Comment"



317 Elm Street
 Milford, NH 03055
 (603) 673-5440
 Sales@chemservelab.com

Contocook Valley School District
 Tim Grossi
 106 Hancock Road
 Peterborough NH 03458

Control #: 19060241
 Project Number: N/A
 Project Name: Peterborough Elementary School
 Project Location: SCH-22310

Analytical Results

Lab ID: 19060241
 Date: 7/25/2019

Sample	Method	Client Sample Identity	Units	Matrix	Analyst
19060241-001	EPA 200.5 Rev 4.2	Nurses Office Sink		Drinking Water	CharleneF

Start Date/Time Sampled: 6/25/2019 12:27:00 PM Composite End Date/Time:

Parameter	CAS Number	Result	Qualifier	Date/Time Analyzed	RDL	Analyst
Hot Plate Digestion				7/11/2019	0	harleneF
Lead	7439-92-1	< 0.003 mg/L		7/12/2019	0.003	BenN

Sample	Method	Client Sample Identity	Units	Matrix	Analyst
19060241-002	EPA 200.5 Rev 4.2	Nurses BR Sink		Drinking Water	CharleneF

Start Date/Time Sampled: 6/25/2019 12:28:00 PM Composite End Date/Time:

Parameter	CAS Number	Result	Qualifier	Date/Time Analyzed	RDL	Analyst
Hot Plate Digestion				7/11/2019	0	harleneF
Lead	7439-92-1	< 0.003 mg/L		7/12/2019	0.003	BenN

Sample	Method	Client Sample Identity	Units	Matrix	Analyst
19060241-003	EPA 200.5 Rev 4.2	Office BR		Drinking Water	CharleneF

Start Date/Time Sampled: 6/25/2019 12:24:00 PM Composite End Date/Time:

Parameter	CAS Number	Result	Qualifier	Date/Time Analyzed	RDL	Analyst
Hot Plate Digestion				7/11/2019	0	harleneF
Lead	7439-92-1	< 0.003 mg/L		7/12/2019	0.003	BenN

Sample	Method	Client Sample Identity	Units	Matrix	Analyst
19060241-004	EPA 200.5 Rev 4.2	Rm 116 Sink		Drinking Water	CharleneF

Start Date/Time Sampled: 6/25/2019 12:16:00 PM Composite End Date/Time:

Parameter	CAS Number	Result	Qualifier	Date/Time Analyzed	RDL	Analyst
Hot Plate Digestion				7/11/2019	0	harleneF
Lead	7439-92-1	< 0.003 mg/L		7/12/2019	0.003	BenN



317 Elm Street
 Milford, NH 03055
 (603) 673-5440
 Sales@chemservelab.com

Sample	Method	Client Sample Identity	Units	Matrix	Analyst
19060241-006	EPA 200.5 Rev 4.2	Rm 128 West BR Sink		Drinking Water	CharleneF

Start Date/Time Sampled: 6/25/2019 1:16:00 PM Composite End Date/Time:

Parameter	CAS Number	Result	Qualifier	Date/Time Analyzed	RDL	Analyst
Hot Plate Digestion				7/11/2019	0	harleneF
Lead	7439-92-1	< 0.003 mg/L		7/12/2019	0.003	BenN

Sample	Method	Client Sample Identity	Units	Matrix	Analyst
19060241-007	EPA 200.5 Rev 4.2	Rm 128 Sink		Drinking Water	CharleneF

Start Date/Time Sampled: 6/25/2019 1:17:00 PM Composite End Date/Time:

Parameter	CAS Number	Result	Qualifier	Date/Time Analyzed	RDL	Analyst
Hot Plate Digestion				7/11/2019	0	harleneF
Lead	7439-92-1	< 0.003 mg/L		7/12/2019	0.003	BenN

Sample	Method	Client Sample Identity	Units	Matrix	Analyst
19060241-009	EPA 200.5 Rev 4.2	Rm 130 rgt BR Sink		Drinking Water	CharleneF

Start Date/Time Sampled: 6/25/2019 12:11:00 PM Composite End Date/Time:

Parameter	CAS Number	Result	Qualifier	Date/Time Analyzed	RDL	Analyst
Hot Plate Digestion				7/11/2019	0	harleneF
Lead	7439-92-1	0.005 mg/L		7/12/2019	0.003	BenN

Sample	Method	Client Sample Identity	Units	Matrix	Analyst
19060241-010	EPA 200.5 Rev 4.2	Rm 130 lft BR Sink		Drinking Water	CharleneF

Start Date/Time Sampled: 6/25/2019 12:11:00 PM Composite End Date/Time:

Parameter	CAS Number	Result	Qualifier	Date/Time Analyzed	RDL	Analyst
Hot Plate Digestion				7/11/2019	0	harleneF
Lead	7439-92-1	< 0.003 mg/L		7/12/2019	0.003	BenN

Sample	Method	Client Sample Identity	Units	Matrix	Analyst
19060241-011	EPA 200.5 Rev 4.2	Rm 130 Kitchenette Sink		Drinking Water	CharleneF

Start Date/Time Sampled: 6/25/2019 12:12:00 PM Composite End Date/Time:

Parameter	CAS Number	Result	Qualifier	Date/Time Analyzed	RDL	Analyst
Hot Plate Digestion				7/11/2019	0	harleneF
Lead	7439-92-1	0.005 mg/L		7/12/2019	0.003	BenN



317 Elm Street
 Milford, NH 03055
 (603) 673-5440
 Sales@chemservelab.com

Sample	Method	Client Sample Identity	Units	Matrix	Analyst
19060241-012	EPA 200.5 Rev 4.2	Rm 140 Sink		Drinking Water	CharleneF

Start Date/Time Sampled: 6/25/2019 12:05:00 PM Composite End Date/Time:

Parameter	CAS Number	Result	Qualifier	Date/Time Analyzed	RDL	Analyst
Hot Plate Digestion				7/11/2019	0	harleneF
Lead	7439-92-1	< 0.003 mg/L		7/12/2019	0.003	BenN

Sample	Method	Client Sample Identity	Units	Matrix	Analyst
19060241-013	EPA 200.5 Rev 4.2	Rm 142 Sink		Drinking Water	CharleneF

Start Date/Time Sampled: 6/25/2019 12:06:00 PM Composite End Date/Time:

Parameter	CAS Number	Result	Qualifier	Date/Time Analyzed	RDL	Analyst
Hot Plate Digestion				7/11/2019	0	harleneF
Lead	7439-92-1	< 0.003 mg/L		7/12/2019	0.003	BenN

Sample	Method	Client Sample Identity	Units	Matrix	Analyst
19060241-014	EPA 200.5 Rev 4.2	Rm 144 Sink		Drinking Water	CharleneF

Start Date/Time Sampled: 6/25/2019 11:52:00 AM Composite End Date/Time:

Parameter	CAS Number	Result	Qualifier	Date/Time Analyzed	RDL	Analyst
Hot Plate Digestion				7/11/2019	0	harleneF
Lead	7439-92-1	< 0.003 mg/L		7/12/2019	0.003	BenN

Sample	Method	Client Sample Identity	Units	Matrix	Analyst
19060241-015	EPA 200.5 Rev 4.2	Rm 145 Sink		Drinking Water	CharleneF

Start Date/Time Sampled: 6/25/2019 11:52:00 AM Composite End Date/Time:

Parameter	CAS Number	Result	Qualifier	Date/Time Analyzed	RDL	Analyst
Hot Plate Digestion				7/11/2019	0	harleneF
Lead	7439-92-1	< 0.003 mg/L		7/12/2019	0.003	BenN

Sample	Method	Client Sample Identity	Units	Matrix	Analyst
19060241-016	EPA 200.5 Rev 4.2	Rm 143 Sink		Drinking Water	CharleneF

Start Date/Time Sampled: 6/25/2019 12:04:00 PM Composite End Date/Time:

Parameter	CAS Number	Result	Qualifier	Date/Time Analyzed	RDL	Analyst
Hot Plate Digestion				7/11/2019	0	harleneF
Lead	7439-92-1	< 0.003 mg/L		7/12/2019	0.003	BenN

Sample	Method	Client Sample Identity	Units	Matrix	Analyst
19060241-017	EPA 200.5 Rev 4.2	Rm 141 Sink		Drinking Water	CharleneF

Start Date/Time Sampled: 6/25/2019 12:06:00 PM Composite End Date/Time:

Parameter	CAS Number	Result	Qualifier	Date/Time Analyzed	RDL	Analyst
Hot Plate Digestion				7/11/2019	0	harleneF
Lead	7439-92-1	< 0.003 mg/L		7/12/2019	0.003	BenN

Sample	Method	Client Sample Identity	Units	Matrix	Analyst
19060241-018	EPA 200.5 Rev 4.2	Kindergarten Staff BR		Drinking Water	CharleneF

Start Date/Time Sampled: 6/25/2019 12:10:00 PM Composite End Date/Time:

Parameter	CAS Number	Result	Qualifier	Date/Time Analyzed	RDL	Analyst
Hot Plate Digestion				7/11/2019	0	harleneF
Lead	7439-92-1	< 0.003 mg/L		7/12/2019	0.003	BenN

Sample	Method	Client Sample Identity	Units	Matrix	Analyst
19060241-019	EPA 200.5 Rev 4.2	Gym Hall Girls BR lft Sink		Drinking Water	CharleneF

Start Date/Time Sampled: 6/25/2019 12:17:00 PM Composite End Date/Time:

Parameter	CAS Number	Result	Qualifier	Date/Time Analyzed	RDL	Analyst
Hot Plate Digestion				7/11/2019	0	harleneF
Lead	7439-92-1	< 0.003 mg/L		7/12/2019	0.003	BenN

Sample	Method	Client Sample Identity	Units	Matrix	Analyst
19060241-020	EPA 200.5 Rev 4.2	Gym Hall Girls BR rgt Sink		Drinking Water	CharleneF

Start Date/Time Sampled: 6/25/2019 12:17:00 PM Composite End Date/Time:

Parameter	CAS Number	Result	Qualifier	Date/Time Analyzed	RDL	Analyst
Hot Plate Digestion				7/11/2019	0	harleneF
Lead	7439-92-1	< 0.003 mg/L		7/12/2019	0.003	BenN

Sample	Method	Client Sample Identity	Units	Matrix	Analyst
19060241-021	EPA 200.5 Rev 4.2	Gym Hall WF Next to BRs		Drinking Water	CharleneF

Start Date/Time Sampled: 6/25/2019 12:18:00 PM Composite End Date/Time:

Parameter	CAS Number	Result	Qualifier	Date/Time Analyzed	RDL	Analyst
Hot Plate Digestion				7/11/2019	0	harleneF
Lead	7439-92-1	< 0.003 mg/L		7/12/2019	0.003	BenN



317 Elm Street
 Milford, NH 03055
 (603) 673-5440
 Sales@chemservelab.com

Sample	Method	Client Sample Identity	Units	Matrix	Analyst
19060241-022	EPA 200.5 Rev 4.2	Gym Hall Boys BR rgt Sink		Drinking Water	CharleneF

Start Date/Time Sampled: 6/25/2019 12:23:00 PM Composite End Date/Time:

Parameter	CAS Number	Result	Qualifier	Date/Time Analyzed	RDL	Analyst
Hot Plate Digestion				7/11/2019	0	harleneF
Lead	7439-92-1	< 0.003 mg/L		7/12/2019	0.003	BenN

Sample	Method	Client Sample Identity	Units	Matrix	Analyst
19060241-023	EPA 200.5 Rev 4.2	Gym Hall Boys BR lft Sink		Drinking Water	CharleneF

Start Date/Time Sampled: 6/25/2019 12:25:00 PM Composite End Date/Time:

Parameter	CAS Number	Result	Qualifier	Date/Time Analyzed	RDL	Analyst
Hot Plate Digestion				7/11/2019	0	harleneF
Lead	7439-92-1	< 0.003 mg/L		7/12/2019	0.003	BenN

Sample	Method	Client Sample Identity	Units	Matrix	Analyst
19060241-024	EPA 200.5 Rev 4.2	Gym Hall WF by Library		Drinking Water	CharleneF

Start Date/Time Sampled: 6/25/2019 12:25:00 PM Composite End Date/Time:

Parameter	CAS Number	Result	Qualifier	Date/Time Analyzed	RDL	Analyst
Hot Plate Digestion				7/11/2019	0	harleneF
Lead	7439-92-1	< 0.003 mg/L		7/12/2019	0.003	BenN

Sample	Method	Client Sample Identity	Units	Matrix	Analyst
19060241-025	EPA 200.5 Rev 4.2	Rm 150 Sink		Drinking Water	CharleneF

Start Date/Time Sampled: 6/25/2019 11:47:00 AM Composite End Date/Time:

Parameter	CAS Number	Result	Qualifier	Date/Time Analyzed	RDL	Analyst
Hot Plate Digestion				7/11/2019	0	harleneF
Lead	7439-92-1	0.003 mg/L		7/12/2019	0.003	BenN

Sample	Method	Client Sample Identity	Units	Matrix	Analyst
19060241-027	EPA 200.5 Rev 4.2	Rm 152 Sink		Drinking Water	CharleneF

Start Date/Time Sampled: 6/25/2019 11:38:00 AM Composite End Date/Time:

Parameter	CAS Number	Result	Qualifier	Date/Time Analyzed	RDL	Analyst
Hot Plate Digestion				7/11/2019	0	harleneF
Lead	7439-92-1	< 0.003 mg/L		7/12/2019	0.003	BenN



317 Elm Street
 Milford, NH 03055
 (603) 673-5440
 Sales@chemservelab.com

Sample	Method	Client Sample Identity	Units	Matrix	Analyst
19060241-029	EPA 200.5 Rev 4.2	Rm 154 Sink		Drinking Water	CharleneF

Start Date/Time Sampled: 6/25/2019 11:36:00 AM Composite End Date/Time:

Parameter	CAS Number	Result	Qualifier	Date/Time Analyzed	RDL	Analyst
Hot Plate Digestion				7/11/2019	0	harleneF
Lead	7439-92-1	< 0.003 mg/L		7/12/2019	0.003	BenN

Sample	Method	Client Sample Identity	Units	Matrix	Analyst
19060241-031	EPA 200.5 Rev 4.2	Rm 155 Sink		Drinking Water	CharleneF

Start Date/Time Sampled: 6/25/2019 11:35:00 AM Composite End Date/Time:

Parameter	CAS Number	Result	Qualifier	Date/Time Analyzed	RDL	Analyst
Hot Plate Digestion				7/11/2019	0	harleneF
Lead	7439-92-1	< 0.003 mg/L		7/12/2019	0.003	BenN

Sample	Method	Client Sample Identity	Units	Matrix	Analyst
19060241-032	EPA 200.5 Rev 4.2	Rm 153 Sink		Drinking Water	CharleneF

Start Date/Time Sampled: 6/25/2019 11:45:00 AM Composite End Date/Time:

Parameter	CAS Number	Result	Qualifier	Date/Time Analyzed	RDL	Analyst
Hot Plate Digestion				7/11/2019	0	harleneF
Lead	7439-92-1	< 0.003 mg/L		7/12/2019	0.003	BenN

Sample	Method	Client Sample Identity	Units	Matrix	Analyst
19060241-034	EPA 200.5 Rev 4.2	Rm 151 Sink		Drinking Water	CharleneF

Start Date/Time Sampled: 6/25/2019 11:43:00 AM Composite End Date/Time:

Parameter	CAS Number	Result	Qualifier	Date/Time Analyzed	RDL	Analyst
Hot Plate Digestion				7/11/2019	0	harleneF
Lead	7439-92-1	< 0.003 mg/L		7/12/2019	0.003	BenN

Sample	Method	Client Sample Identity	Units	Matrix	Analyst
19060241-035	EPA 200.5 Rev 4.2	Rm 151 WF		Drinking Water	CharleneF

Start Date/Time Sampled: 6/25/2019 11:43:00 AM Composite End Date/Time:

Parameter	CAS Number	Result	Qualifier	Date/Time Analyzed	RDL	Analyst
Hot Plate Digestion				7/11/2019	0	harleneF
Lead	7439-92-1	< 0.003 mg/L		7/12/2019	0.003	BenN



317 Elm Street
 Milford, NH 03055
 (603) 673-5440
 Sales@chemservelab.com

Sample	Method	Client Sample Identity	Units	Matrix	Analyst
19060241-036	EPA 200.5 Rev 4.2	150-155 ClssRm hll WF		Drinking Water	CharleneF

Start Date/Time Sampled: 6/25/2019 11:36:00 AM Composite End Date/Time:

Parameter	CAS Number	Result	Qualifier	Date/Time Analyzed	RDL	Analyst
Hot Plate Digestion				7/11/2019	0	harleneF
Lead	7439-92-1	< 0.003 mg/L		7/12/2019	0.003	BenN

Sample	Method	Client Sample Identity	Units	Matrix	Analyst
19060241-037	EPA 200.5 Rev 4.2	Basement irls BR lft Snk		Drinking Water	CharleneF

Start Date/Time Sampled: 6/25/2019 12:29:00 PM Composite End Date/Time:

Parameter	CAS Number	Result	Qualifier	Date/Time Analyzed	RDL	Analyst
Hot Plate Digestion				7/11/2019	0	harleneF
Lead	7439-92-1	< 0.003 mg/L		7/12/2019	0.003	BenN

Sample	Method	Client Sample Identity	Units	Matrix	Analyst
19060241-038	EPA 200.5 Rev 4.2	Basement Girls BR rgt Sink		Drinking Water	CharleneF

Start Date/Time Sampled: 6/25/2019 12:28:00 PM Composite End Date/Time:

Parameter	CAS Number	Result	Qualifier	Date/Time Analyzed	RDL	Analyst
Hot Plate Digestion				7/11/2019	0	harleneF
Lead	7439-92-1	< 0.003 mg/L		7/12/2019	0.003	BenN

Sample	Method	Client Sample Identity	Units	Matrix	Analyst
19060241-039	EPA 200.5 Rev 4.2	Basement Boys BR lft Sink		Drinking Water	CharleneF

Start Date/Time Sampled: 6/25/2019 12:29:00 PM Composite End Date/Time:

Parameter	CAS Number	Result	Qualifier	Date/Time Analyzed	RDL	Analyst
Hot Plate Digestion				7/11/2019	0	harleneF
Lead	7439-92-1	< 0.003 mg/L		7/12/2019	0.003	BenN

Sample	Method	Client Sample Identity	Units	Matrix	Analyst
19060241-040	EPA 200.5 Rev 4.2	Basement Boys BR rgt Sink		Drinking Water	CharleneF

Start Date/Time Sampled: 6/25/2019 12:21:00 PM Composite End Date/Time:

Parameter	CAS Number	Result	Qualifier	Date/Time Analyzed	RDL	Analyst
Hot Plate Digestion				7/11/2019	0	harleneF
Lead	7439-92-1	< 0.003 mg/L		7/12/2019	0.003	BenN



317 Elm Street
 Milford, NH 03055
 (603) 673-5440
 Sales@chemservelab.com

Sample	Method	Client Sample Identity	Units	Matrix	Analyst
19060241-041	EPA 200.5 Rev 4.2	Basement WF		Drinking Water	CharleneF

Start Date/Time Sampled: 6/25/2019 12:30:00 PM Composite End Date/Time:

Parameter	CAS Number	Result	Qualifier	Date/Time Analyzed	RDL	Analyst
Hot Plate Digestion				7/11/2019	0	harleneF
Lead	7439-92-1	< 0.003 mg/L		7/12/2019	0.003	BenN

Sample	Method	Client Sample Identity	Units	Matrix	Analyst
19060241-042	EPA 200.5 Rev 4.2	Rm 50 BR Sink		Drinking Water	CharleneF

Start Date/Time Sampled: 6/25/2019 12:32:00 PM Composite End Date/Time:

Parameter	CAS Number	Result	Qualifier	Date/Time Analyzed	RDL	Analyst
Hot Plate Digestion				7/11/2019	0	harleneF
Lead	7439-92-1	< 0.003 mg/L		7/12/2019	0.003	BenN

Sample	Method	Client Sample Identity	Units	Matrix	Analyst
19060241-043	EPA 200.5 Rev 4.2	Rm 52 Sink		Drinking Water	CharleneF

Start Date/Time Sampled: 6/25/2019 12:33:00 PM Composite End Date/Time:

Parameter	CAS Number	Result	Qualifier	Date/Time Analyzed	RDL	Analyst
Hot Plate Digestion				7/11/2019	0	harleneF
Lead	7439-92-1	< 0.003 mg/L		7/12/2019	0.003	BenN

Sample	Method	Client Sample Identity	Units	Matrix	Analyst
19060241-044	EPA 200.5 Rev 4.2	Rm 54 Sink		Drinking Water	CharleneF

Start Date/Time Sampled: 6/25/2019 12:41:00 PM Composite End Date/Time:

Parameter	CAS Number	Result	Qualifier	Date/Time Analyzed	RDL	Analyst
Hot Plate Digestion				7/11/2019	0	harleneF
Lead	7439-92-1	< 0.003 mg/L		7/12/2019	0.003	BenN

Sample	Method	Client Sample Identity	Units	Matrix	Analyst
19060241-045	EPA 200.5 Rev 4.2	Rm 55 Sink		Drinking Water	CharleneF

Start Date/Time Sampled: 6/25/2019 12:41:00 PM Composite End Date/Time:

Parameter	CAS Number	Result	Qualifier	Date/Time Analyzed	RDL	Analyst
Hot Plate Digestion				7/11/2019	0	harleneF
Lead	7439-92-1	< 0.003 mg/L		7/12/2019	0.003	BenN

Sample	Method	Client Sample Identity	Units	Matrix	Analyst
19060241-046	EPA 200.5 Rev 4.2	Rm 53 Sink		Drinking Water	CharleneF

Start Date/Time Sampled: 6/25/2019 12:40:00 PM Composite End Date/Time:

Parameter	CAS Number	Result	Qualifier	Date/Time Analyzed	RDL	Analyst
Hot Plate Digestion				7/11/2019	0	harleneF
Lead	7439-92-1	< 0.003 mg/L		7/12/2019	0.003	BenN

Sample	Method	Client Sample Identity	Units	Matrix	Analyst
19060241-047	EPA 200.5 Rev 4.2	Rm 51 Sink		Drinking Water	CharleneF

Start Date/Time Sampled: 6/25/2019 12:32:00 PM Composite End Date/Time:

Parameter	CAS Number	Result	Qualifier	Date/Time Analyzed	RDL	Analyst
Hot Plate Digestion				7/11/2019	0	harleneF
Lead	7439-92-1	< 0.003 mg/L		7/12/2019	0.003	BenN

Sample	Method	Client Sample Identity	Units	Matrix	Analyst
19060241-048	EPA 200.5 Rev 4.2	Rms 250-255 hall BR		Drinking Water	CharleneF

Start Date/Time Sampled: 6/25/2019 12:48:00 PM Composite End Date/Time:

Parameter	CAS Number	Result	Qualifier	Date/Time Analyzed	RDL	Analyst
Hot Plate Digestion				7/11/2019	0	harleneF
Lead	7439-92-1	< 0.003 mg/L		7/12/2019	0.003	BenN

Sample	Method	Client Sample Identity	Units	Matrix	Analyst
19060241-049	EPA 200.5 Rev 4.2	Rm 250 WF		Drinking Water	CharleneF

Start Date/Time Sampled: 6/25/2019 12:48:00 PM Composite End Date/Time:

Parameter	CAS Number	Result	Qualifier	Date/Time Analyzed	RDL	Analyst
Hot Plate Digestion				7/11/2019	0	harleneF
Lead	7439-92-1	0.016 mg/L		7/12/2019	0.003	BenN

Sample	Method	Client Sample Identity	Units	Matrix	Analyst
19060241-050	EPA 200.5 Rev 4.2	Rm 250 Sink		Drinking Water	CharleneF

Start Date/Time Sampled: 6/25/2019 12:49:00 PM Composite End Date/Time:

Parameter	CAS Number	Result	Qualifier	Date/Time Analyzed	RDL	Analyst
Hot Plate Digestion				7/11/2019	0	harleneF
Lead	7439-92-1	< 0.003 mg/L		7/12/2019	0.003	BenN



317 Elm Street
 Milford, NH 03055
 (603) 673-5440
 Sales@chemservelab.com

Sample	Method	Client Sample Identity	Units	Matrix	Analyst
19060241-051	EPA 200.5 Rev 4.2	Rm 252 Sink		Drinking Water	CharleneF

Start Date/Time Sampled: 6/25/2019 12:52:00 PM Composite End Date/Time:

Parameter	CAS Number	Result	Qualifier	Date/Time Analyzed	RDL	Analyst
Hot Plate Digestion				7/11/2019	0	harleneF
Lead	7439-92-1	< 0.003 mg/L		7/12/2019	0.003	BenN

Sample	Method	Client Sample Identity	Units	Matrix	Analyst
19060241-052	EPA 200.5 Rev 4.2	Rm 254 Sink		Drinking Water	CharleneF

Start Date/Time Sampled: 6/25/2019 12:44:00 PM Composite End Date/Time:

Parameter	CAS Number	Result	Qualifier	Date/Time Analyzed	RDL	Analyst
Hot Plate Digestion				7/11/2019	0	harleneF
Lead	7439-92-1	< 0.003 mg/L		7/12/2019	0.003	BenN

Sample	Method	Client Sample Identity	Units	Matrix	Analyst
19060241-055	EPA 200.5 Rev 4.2	Rm 255 Sink		Drinking Water	CharleneF

Start Date/Time Sampled: 6/25/2019 12:44:00 PM Composite End Date/Time:

Parameter	CAS Number	Result	Qualifier	Date/Time Analyzed	RDL	Analyst
Hot Plate Digestion				7/11/2019	0	harleneF
Lead	7439-92-1	< 0.003 mg/L		7/12/2019	0.003	BenN

Sample	Method	Client Sample Identity	Units	Matrix	Analyst
19060241-056	EPA 200.5 Rev 4.2	Rm 253 Sink		Drinking Water	CharleneF

Start Date/Time Sampled: 6/25/2019 12:51:00 PM Composite End Date/Time:

Parameter	CAS Number	Result	Qualifier	Date/Time Analyzed	RDL	Analyst
Hot Plate Digestion				7/11/2019	0	harleneF
Lead	7439-92-1	< 0.003 mg/L		7/12/2019	0.003	BenN

Sample	Method	Client Sample Identity	Units	Matrix	Analyst
19060241-058	EPA 200.5 Rev 4.2	Rm 251 WF		Drinking Water	CharleneF

Start Date/Time Sampled: 6/25/2019 12:50:00 PM Composite End Date/Time:

Parameter	CAS Number	Result	Qualifier	Date/Time Analyzed	RDL	Analyst
Hot Plate Digestion				7/11/2019	0	harleneF
Lead	7439-92-1	< 0.003 mg/L		7/12/2019	0.003	BenN

Sample	Method	Client Sample Identity	Units	Matrix	Analyst
19060241-059	EPA 200.5 Rev 4.2	Rm 251 Sink		Drinking Water	CharleneF

Start Date/Time Sampled: 6/25/2019 12:50:00 PM Composite End Date/Time:

Parameter	CAS Number	Result	Qualifier	Date/Time Analyzed	RDL	Analyst
Hot Plate Digestion				7/11/2019	0	harleneF
Lead	7439-92-1	< 0.003 mg/L		7/12/2019	0.003	BenN

Sample	Method	Client Sample Identity	Units	Matrix	Analyst
19060241-060	EPA 200.5 Rev 4.2	250-255 hall WF		Drinking Water	CharleneF

Start Date/Time Sampled: 6/25/2019 12:53:00 PM Composite End Date/Time:

Parameter	CAS Number	Result	Qualifier	Date/Time Analyzed	RDL	Analyst
Hot Plate Digestion				7/11/2019	0	harleneF
Lead	7439-92-1	< 0.003 mg/L		7/12/2019	0.003	BenN

Sample	Method	Client Sample Identity	Units	Matrix	Analyst
19060241-061	EPA 200.5 Rev 4.2	Cafe hll Bys BR lft Snk		Drinking Water	CharleneF

Start Date/Time Sampled: 6/25/2019 12:01:00 PM Composite End Date/Time:

Parameter	CAS Number	Result	Qualifier	Date/Time Analyzed	RDL	Analyst
Hot Plate Digestion				7/11/2019	0	harleneF
Lead	7439-92-1	< 0.003 mg/L		7/12/2019	0.003	BenN

Sample	Method	Client Sample Identity	Units	Matrix	Analyst
19060241-062	EPA 200.5 Rev 4.2	Cafe hall Bys BR rgt Snk		Drinking Water	CharleneF

Start Date/Time Sampled: 6/25/2019 12:00:00 PM Composite End Date/Time:

Parameter	CAS Number	Result	Qualifier	Date/Time Analyzed	RDL	Analyst
Hot Plate Digestion				7/11/2019	0	harleneF
Lead	7439-92-1	< 0.003 mg/L		7/12/2019	0.003	BenN

Sample	Method	Client Sample Identity	Units	Matrix	Analyst
19060241-063	EPA 200.5 Rev 4.2	Cafe hall Bys BR Mddl Snk		Drinking Water	CharleneF

Start Date/Time Sampled: 6/25/2019 12:00:00 PM Composite End Date/Time:

Parameter	CAS Number	Result	Qualifier	Date/Time Analyzed	RDL	Analyst
Hot Plate Digestion				7/11/2019	0	harleneF
Lead	7439-92-1	< 0.003 mg/L		7/12/2019	0.003	BenN



317 Elm Street
 Milford, NH 03055
 (603) 673-5440
 Sales@chemservelab.com

Sample	Method	Client Sample Identity	Units	Matrix	Analyst
19060241-064	EPA 200.5 Rev 4.2	Cafe hall lft Side Adult BR Snk		Drinking Water	CharleneF

Start Date/Time Sampled: 6/25/2019 11:59:00 AM Composite End Date/Time:

Parameter	CAS Number	Result	Qualifier	Date/Time Analyzed	RDL	Analyst
Hot Plate Digestion				7/11/2019	0	harleneF
Lead	7439-92-1	< 0.003 mg/L		7/12/2019	0.003	BenN

Sample	Method	Client Sample Identity	Units	Matrix	Analyst
19060241-065	EPA 200.5 Rev 4.2	Cafe hll rgt Side Adult BR Snk		Drinking Water	CharleneF

Start Date/Time Sampled: 6/25/2019 11:59:00 AM Composite End Date/Time:

Parameter	CAS Number	Result	Qualifier	Date/Time Analyzed	RDL	Analyst
Hot Plate Digestion				7/11/2019	0	harleneF
Lead	7439-92-1	< 0.003 mg/L		7/12/2019	0.003	BenN

Sample	Method	Client Sample Identity	Units	Matrix	Analyst
19060241-066	EPA 200.5 Rev 4.2	Cafe hall Girls BR lft Sink		Drinking Water	CharleneF

Start Date/Time Sampled: 6/25/2019 11:57:00 AM Composite End Date/Time:

Parameter	CAS Number	Result	Qualifier	Date/Time Analyzed	RDL	Analyst
Hot Plate Digestion				7/11/2019	0	harleneF
Lead	7439-92-1	< 0.003 mg/L		7/12/2019	0.003	BenN

Sample	Method	Client Sample Identity	Units	Matrix	Analyst
19060241-067	EPA 200.5 Rev 4.2	Cafe hall Girls BR rgt Sink		Drinking Water	CharleneF

Start Date/Time Sampled: 6/25/2019 11:58:00 AM Composite End Date/Time:

Parameter	CAS Number	Result	Qualifier	Date/Time Analyzed	RDL	Analyst
Hot Plate Digestion				7/11/2019	0	harleneF
Lead	7439-92-1	< 0.003 mg/L		7/12/2019	0.003	BenN

Sample	Method	Client Sample Identity	Units	Matrix	Analyst
19060241-068	EPA 200.5 Rev 4.2	Cafe hall Girls BR Middle Sink		Drinking Water	CharleneF

Start Date/Time Sampled: 6/25/2019 11:57:00 AM Composite End Date/Time:

Parameter	CAS Number	Result	Qualifier	Date/Time Analyzed	RDL	Analyst
Hot Plate Digestion				7/11/2019	0	harleneF
Lead	7439-92-1	< 0.003 mg/L		7/12/2019	0.003	BenN



317 Elm Street
 Milford, NH 03055
 (603) 673-5440
 Sales@chemservelab.com

Sample	Method	Client Sample Identity	Units	Matrix	Analyst
19060241-069	EPA 200.5 Rev 4.2	Boiler Rm Sink		Drinking Water	CharleneF

Start Date/Time Sampled: 6/25/2019 11:50:00 AM Composite End Date/Time:

Parameter	CAS Number	Result	Qualifier	Date/Time Analyzed	RDL	Analyst
Hot Plate Digestion				7/11/2019	0	harleneF
Lead	7439-92-1	0.004 mg/L		7/12/2019	0.003	BenN

Sample	Method	Client Sample Identity	Units	Matrix	Analyst
19060241-070	EPA 200.5 Rev 4.2	Sink to lft of Oven		Drinking Water	CharleneF

Start Date/Time Sampled: 6/25/2019 11:47:00 AM Composite End Date/Time:

Parameter	CAS Number	Result	Qualifier	Date/Time Analyzed	RDL	Analyst
Hot Plate Digestion				7/11/2019	0	harleneF
Lead	7439-92-1	< 0.003 mg/L		7/12/2019	0.003	BenN

Sample	Method	Client Sample Identity	Units	Matrix	Analyst
19060241-071	EPA 200.5 Rev 4.2	Sink to rgt of Exterior Door		Drinking Water	CharleneF

Start Date/Time Sampled: 6/25/2019 11:45:00 AM Composite End Date/Time:

Parameter	CAS Number	Result	Qualifier	Date/Time Analyzed	RDL	Analyst
Hot Plate Digestion				7/11/2019	0	harleneF
Lead	7439-92-1	< 0.003 mg/L		7/12/2019	0.003	BenN

Sample	Method	Client Sample Identity	Units	Matrix	Analyst
19060241-072	EPA 200.5 Rev 4.2	Sink to lft of Dish Washer		Drinking Water	CharleneF

Start Date/Time Sampled: 6/25/2019 11:46:00 AM Composite End Date/Time:

Parameter	CAS Number	Result	Qualifier	Date/Time Analyzed	RDL	Analyst
Hot Plate Digestion				7/11/2019	0	harleneF
Lead	7439-92-1	0.006 mg/L		7/12/2019	0.003	BenN

Sample	Method	Client Sample Identity	Units	Matrix	Analyst
19060241-073	EPA 200.5 Rev 4.2	Boys Handicap Stall Sink		Drinking Water	CharleneF

Start Date/Time Sampled: 6/25/2019 12:09:00 PM Composite End Date/Time:

Parameter	CAS Number	Result	Qualifier	Date/Time Analyzed	RDL	Analyst
Hot Plate Digestion				7/11/2019	0	harleneF
Lead	7439-92-1	< 0.003 mg/L		7/12/2019	0.003	BenN



317 Elm Street
 Milford, NH 03055
 (603) 673-5440
 Sales@chemservelab.com

Sample	Method	Client Sample Identity	Units	Matrix	Analyst
19060241-074	EPA 200.5 Rev 4.2	Boys BR lft Sink		Drinking Water	CharleneF

Start Date/Time Sampled: 6/25/2019 12:09:00 PM Composite End Date/Time:

Parameter	CAS Number	Result	Qualifier	Date/Time Analyzed	RDL	Analyst
Hot Plate Digestion				7/11/2019	0	harleneF
Lead	7439-92-1	0.008 mg/L		7/12/2019	0.003	BenN

Sample	Method	Client Sample Identity	Units	Matrix	Analyst
19060241-075	EPA 200.5 Rev 4.2	Boys BR rgt Sink		Drinking Water	CharleneF

Start Date/Time Sampled: 6/25/2019 12:10:00 PM Composite End Date/Time:

Parameter	CAS Number	Result	Qualifier	Date/Time Analyzed	RDL	Analyst
Hot Plate Digestion				7/11/2019	0	harleneF
Lead	7439-92-1	< 0.003 mg/L		7/12/2019	0.003	BenN

Sample	Method	Client Sample Identity	Units	Matrix	Analyst
19060241-076	EPA 200.5 Rev 4.2	Girls BR rgt Sink		Drinking Water	CharleneF

Start Date/Time Sampled: 6/25/2019 12:12:00 PM Composite End Date/Time:

Parameter	CAS Number	Result	Qualifier	Date/Time Analyzed	RDL	Analyst
Hot Plate Digestion				7/11/2019	0	harleneF
Lead	7439-92-1	< 0.003 mg/L		7/12/2019	0.003	BenN

Sample	Method	Client Sample Identity	Units	Matrix	Analyst
19060241-077	EPA 200.5 Rev 4.2	Girls BR lft Sink		Drinking Water	CharleneF

Start Date/Time Sampled: 6/25/2019 12:12:00 PM Composite End Date/Time:

Parameter	CAS Number	Result	Qualifier	Date/Time Analyzed	RDL	Analyst
Hot Plate Digestion				7/11/2019	0	harleneF
Lead	7439-92-1	< 0.003 mg/L		7/12/2019	0.003	BenN

Sample	Method	Client Sample Identity	Units	Matrix	Analyst
19060241-078	EPA 200.5 Rev 4.2	Girls BR Handicap Stall Sink		Drinking Water	CharleneF

Start Date/Time Sampled: 6/25/2019 12:11:00 PM Composite End Date/Time:

Parameter	CAS Number	Result	Qualifier	Date/Time Analyzed	RDL	Analyst
Hot Plate Digestion				7/11/2019	0	harleneF
Lead	7439-92-1	< 0.003 mg/L		7/12/2019	0.003	BenN

Sample	Method	Client Sample Identity	Units	Matrix	Analyst
19060241-079	EPA 200.5 Rev 4.2	Art Rm 103 lft Sink		Drinking Water	CharleneF

Start Date/Time Sampled: 6/25/2019 12:21:00 PM Composite End Date/Time:

Parameter	CAS Number	Result	Qualifier	Date/Time Analyzed	RDL	Analyst
Hot Plate Digestion				7/11/2019	0	harleneF
Lead	7439-92-1	< 0.003 mg/L		7/12/2019	0.003	BenN

Sample	Method	Client Sample Identity	Units	Matrix	Analyst
19060241-080	EPA 200.5 Rev 4.2	Art Rm 103 rgt Sink		Drinking Water	CharleneF

Start Date/Time Sampled: 6/25/2019 12:21:00 PM Composite End Date/Time:

Parameter	CAS Number	Result	Qualifier	Date/Time Analyzed	RDL	Analyst
Hot Plate Digestion				7/11/2019	0	harleneF
Lead	7439-92-1	< 0.003 mg/L		7/12/2019	0.003	BenN

Sample	Method	Client Sample Identity	Units	Matrix	Analyst
19060241-081	EPA 200.5 Rev 4.2	Office hall WF		Drinking Water	CharleneF

Start Date/Time Sampled: 6/25/2019 12:19:00 PM Composite End Date/Time:

Parameter	CAS Number	Result	Qualifier	Date/Time Analyzed	RDL	Analyst
Hot Plate Digestion				7/11/2019	0	harleneF
Lead	7439-92-1	< 0.003 mg/L		7/12/2019	0.003	BenN

Qualifier: Description:

- B- Method blank contaminated with target analyte.
- B1- BOD had total oxygen loss. Result reported as ">" the highest dilution.
- B2- BOD had no oxygen loss. Result reported as "<" the lowest dilution.
- G- Reporting limit elevated due to matrix interference.
- H- Method prescribed holding time exceeded.
- J- Indicates an estimated value. Value is less than the quantitation limit.
- IL- Internal Standard(s) recovery was low due to matrix. Result may be biased high.
- IH- Internal Standard(s) recovery was high due to matrix. Result may be biased low.
- LH- Laboratory control spike(s) was high. Results may be biased high.
- LL- Laboratory control spike(s) was low. Results may be biased low.
- MH- Matrix spike recovery high due to matrix. Results may be biased high.
- ML- Matrix spike recovery low due to matrix. Results may be biased low.
- N- Non-target compound. Reported as a TIC.
- NC- Spike recovery was not calculated due to the concentration of the analyte being >4 times the concentration of the spike added.
- R- RPD outside acceptable recovery limits.
- RO- Sample received out of holding time.
- SH- Surrogate recovery high due to matrix
- SL- Surrogate recovery low due to matrix
- U- BOD/CBOD blank had an oxygen depletion greater than the suggested amount of 0.200.
- V- Sample pH for analysis was not within the required range when checked at time of analysis.
- Z- Too numerous to count (TNTC)

An "A" in the result column on the report indicates absent for presence/absent bacteria and a "P" indicates present for presence/absent bacteria.

53
 19060241
 7-11-19

Month/Ingl.ac at/Ident/Infltr	Laboratory/Sampl Identifier	Sample/Purpose	Field/Activity/Start/Date	Field/Activity/Start/Time	Sampler/Infltr/InfltrName	Sample/Comments	Laboratory Identifier	Method	Test Method Reference	Analysis/Unit	First Draw	Substance/Con c	Sampler/Comments
Sch-22310	19060241-001	Sample - Routine	6-25-19	12:37	KE	Nurses Office Sink	1008	200.5 or 200.8 USEPA	WATER	Y	LEAD		
Sch-22310	19060241-002	Sample - Routine		12:28	KE	Nurses BR Sink	1008	200.5 or 200.8 USEPA	WATER	Y	LEAD		
Sch-22310	19060241-003	Sample - Routine		12:24	KE	Office BR	1008	200.5 or 200.8 USEPA	WATER	Y	LEAD		
Sch-22310	19060241-004	Sample - Routine		12:16	KE	Rm 110 Sink	1008	200.5 or 200.8 USEPA	WATER	Y	LEAD		
Sch-22310	19060241-005	Sample - Routine		13:16	KE	Gym WF	1008	200.5 or 200.8 USEPA	WATER	Y	LEAD		
Sch-22310	19060241-006	Sample - Routine		13:16	KE	Rm 121 Wood BR Sink	1008	200.5 or 200.8 USEPA	WATER	Y	LEAD		
Sch-22310	19060241-007	Sample - Routine		13:17	KE	Rm 120 Sink	1008	200.5 or 200.8 USEPA	WATER	Y	LEAD		
Sch-22310	19060241-008	Sample - Routine		13:11	KE	Rm 120 Sink	1008	200.5 or 200.8 USEPA	WATER	Y	LEAD		
Sch-22310	19060241-009	Sample - Routine		12:11	KE	Rm 130 qt BR Sink	1008	200.5 or 200.8 USEPA	WATER	Y	LEAD		
Sch-22310	19060241-010	Sample - Routine		12:12	KE	Rm 130 in BR Sink	1008	200.5 or 200.8 USEPA	WATER	Y	LEAD		
Sch-22310	19060241-011	Sample - Routine		12:05	KE	Rm 130 Kleenette Sink	1008	200.5 or 200.8 USEPA	WATER	Y	LEAD		
Sch-22310	19060241-012	Sample - Routine		12:05	KE	Rm 140 Sink	1008	200.5 or 200.8 USEPA	WATER	Y	LEAD		
Sch-22310	19060241-013	Sample - Routine		12:06	KE	Rm 142 Sink	1008	200.5 or 200.8 USEPA	WATER	Y	LEAD		
Sch-22310	19060241-014	Sample - Routine		11:52	KE	Rm 144 Sink	1008	200.5 or 200.8 USEPA	WATER	Y	LEAD		
Sch-22310	19060241-015	Sample - Routine		12:04	KE	Rm 145 Sink	1008	200.5 or 200.8 USEPA	WATER	Y	LEAD		
Sch-22310	19060241-016	Sample - Routine		12:04	KE	Rm 143 Sink	1008	200.5 or 200.8 USEPA	WATER	Y	LEAD		
Sch-22310	19060241-017	Sample - Routine		12:06	KE	Rm 141 Sink	1008	200.5 or 200.8 USEPA	WATER	Y	LEAD		
Sch-22310	19060241-018	Sample - Routine		12:12	KE	Kindergarten Staff BR	1008	200.5 or 200.8 USEPA	WATER	Y	LEAD		
Sch-22310	19060241-019	Sample - Routine		12:17	KE	Gym Hall Sink BR in Sink	1008	200.5 or 200.8 USEPA	WATER	Y	LEAD		
Sch-22310	19060241-020	Sample - Routine		12:17	KE	Gym Hall Sink BR qt Sink	1008	200.5 or 200.8 USEPA	WATER	Y	LEAD		
Sch-22310	19060241-021	Sample - Routine		12:18	KE	Gym Hall WF Next to BRs	1008	200.5 or 200.8 USEPA	WATER	Y	LEAD		
Sch-22310	19060241-022	Sample - Routine		12:25	KE	Gym Hall Boys BR qt Sink	1008	200.5 or 200.8 USEPA	WATER	Y	LEAD		
Sch-22310	19060241-023	Sample - Routine		12:25	KE	Gym Hall Boys BR in Sink	1008	200.5 or 200.8 USEPA	WATER	Y	LEAD		
Sch-22310	19060241-024	Sample - Routine		12:25	KE	Gym Hall WF by Library	1008	200.5 or 200.8 USEPA	WATER	Y	LEAD		
Sch-22310	19060241-025	Sample - Routine		12:25	KE	Rm 150 Sink	1008	200.5 or 200.8 USEPA	WATER	Y	LEAD		
Sch-22310	19060241-026	Sample - Routine		12:25	KE	Rm 150 Sink	1008	200.5 or 200.8 USEPA	WATER	Y	LEAD		
Sch-22310	19060241-027	Sample - Routine		12:25	KE	Rm 150 Sink	1008	200.5 or 200.8 USEPA	WATER	Y	LEAD		
Sch-22310	19060241-028	Sample - Routine		12:25	KE	Rm 152 Sink	1008	200.5 or 200.8 USEPA	WATER	Y	LEAD		
Sch-22310	19060241-029	Sample - Routine		11:34	KE	Rm 154 Sink	1008	200.5 or 200.8 USEPA	WATER	Y	LEAD		
Sch-22310	19060241-030	Sample - Routine		11:35	KE	Rm 155 Sink	1008	200.5 or 200.8 USEPA	WATER	Y	LEAD		
Sch-22310	19060241-031	Sample - Routine		11:35	KE	Rm 153 Sink	1008	200.5 or 200.8 USEPA	WATER	Y	LEAD		
Sch-22310	19060241-032	Sample - Routine		11:35	KE	Rm 155 Sink	1008	200.5 or 200.8 USEPA	WATER	Y	LEAD		
Sch-22310	19060241-033	Sample - Routine		11:35	KE	Rm 153 Sink	1008	200.5 or 200.8 USEPA	WATER	Y	LEAD		
Sch-22310	19060241-034	Sample - Routine		11:35	KE	Rm 151 Sink	1008	200.5 or 200.8 USEPA	WATER	Y	LEAD		
Sch-22310	19060241-035	Sample - Routine		11:35	KE	Rm 151 Sink	1008	200.5 or 200.8 USEPA	WATER	Y	LEAD		
Sch-22310	19060241-036	Sample - Routine		11:34	KE	150-155 Classroom hall WF	1008	200.5 or 200.8 USEPA	WATER	Y	LEAD		
Sch-22310	19060241-037	Sample - Routine		11:34	KE	Basement Girls BR in Sink	1008	200.5 or 200.8 USEPA	WATER	Y	LEAD		
Sch-22310	19060241-038	Sample - Routine		11:34	KE	Basement Girls BR qt Sink	1008	200.5 or 200.8 USEPA	WATER	Y	LEAD		
Sch-22310	19060241-039	Sample - Routine		11:34	KE	Basement Boys BR in Sink	1008	200.5 or 200.8 USEPA	WATER	Y	LEAD		
Sch-22310	19060241-040	Sample - Routine		11:34	KE	Basement Boys BR qt Sink	1008	200.5 or 200.8 USEPA	WATER	Y	LEAD		
Sch-22310	19060241-041	Sample - Routine		11:34	KE	Basement WF	1008	200.5 or 200.8 USEPA	WATER	Y	LEAD		

Requested By: [Signature] Date/Time: 6-25-19 14:15
 Received By: [Signature] Date/Time: 6/28/19 14:15

19060241

Sch-22310	19060241-042	Sample - Routine	6-25-19	1233	KE	Rm 50 BR Sink	1008	200.5 or 200.8	USEPA	WATER	Y	LEAD
Sch-22310	19060241-043	Sample - Routine		1233	KE	Rm 52 Sink	1008	200.5 or 200.8	USEPA	WATER	Y	LEAD
Sch-22310	19060241-044	Sample - Routine		1241	KE	Rm 54 Sink	1008	200.5 or 200.8	USEPA	WATER	Y	LEAD
Sch-22310	19060241-045	Sample - Routine		1241	KE	Rm 55 Sink	1008	200.5 or 200.8	USEPA	WATER	Y	LEAD
Sch-22310	19060241-046	Sample - Routine		1241	KE	Rm 53 Sink	1008	200.5 or 200.8	USEPA	WATER	Y	LEAD
Sch-22310	19060241-047	Sample - Routine		1233	KE	Rm 51 Sink	1008	200.5 or 200.8	USEPA	WATER	Y	LEAD
Sch-22310	19060241-048	Sample - Routine		1248	KE	Rm 250-255 hall BR	1008	200.5 or 200.8	USEPA	WATER	Y	LEAD
Sch-22310	19060241-049	Sample - Routine		1248	KE	Rm 250 WF	1008	200.5 or 200.8	USEPA	WATER	Y	LEAD
Sch-22310	19060241-050	Sample - Routine		1249	KE	Rm 253 Sink	1008	200.5 or 200.8	USEPA	WATER	Y	LEAD
Sch-22310	19060241-051	Sample - Routine		1252	KE	Rm 252 Sink	1008	200.5 or 200.8	USEPA	WATER	Y	LEAD
Sch-22310	19060241-052	Sample - Routine		1244	KE	Rm 254 Sink	1008	200.5 or 200.8	USEPA	WATER	Y	LEAD
Sch-22310	19060241-053	Sample - Routine			KE	Rm 254 WF	1008	200.5 or 200.8	USEPA	WATER	Y	LEAD
Sch-22310	19060241-054	Sample - Routine			KE	Rm 254 WF	1008	200.5 or 200.8	USEPA	WATER	Y	LEAD
Sch-22310	19060241-055	Sample - Routine		1244	KE	Rm 255 Sink	1008	200.5 or 200.8	USEPA	WATER	Y	LEAD
Sch-22310	19060241-056	Sample - Routine		1244	KE	Rm 253 Sink	1008	200.5 or 200.8	USEPA	WATER	Y	LEAD
Sch-22310	19060241-057	Sample - Routine			KE	Rm 253 WF	1008	200.5 or 200.8	USEPA	WATER	Y	LEAD
Sch-22310	19060241-058	Sample - Routine		1252	KE	Rm 251 WF	1008	200.5 or 200.8	USEPA	WATER	Y	LEAD
Sch-22310	19060241-059	Sample - Routine		1252	KE	Rm 251 Sink	1008	200.5 or 200.8	USEPA	WATER	Y	LEAD
Sch-22310	19060241-060	Sample - Routine		1253	KE	250-255 hall WF	1008	200.5 or 200.8	USEPA	WATER	Y	LEAD
Sch-22310	19060241-061	Sample - Routine		1281	KE	Cafe hall Boys BR in Sink	1008	200.5 or 200.8	USEPA	WATER	Y	LEAD
Sch-22310	19060241-062	Sample - Routine		1200	KE	Cafe hall Boys BR in Sink	1008	200.5 or 200.8	USEPA	WATER	Y	LEAD
Sch-22310	19060241-063	Sample - Routine		1200	KE	Cafe hall Boys BR Middle Sink	1008	200.5 or 200.8	USEPA	WATER	Y	LEAD
Sch-22310	19060241-064	Sample - Routine		1157	KE	Cafe hall in Side Adult BR Sink	1008	200.5 or 200.8	USEPA	WATER	Y	LEAD
Sch-22310	19060241-065	Sample - Routine		1157	KE	Cafe hall in Side Adult BR Sink	1008	200.5 or 200.8	USEPA	WATER	Y	LEAD
Sch-22310	19060241-066	Sample - Routine		1157	KE	Cafe hall Gals BR in Sink	1008	200.5 or 200.8	USEPA	WATER	Y	LEAD
Sch-22310	19060241-067	Sample - Routine		1157	KE	Cafe hall Gals BR in Sink	1008	200.5 or 200.8	USEPA	WATER	Y	LEAD
Sch-22310	19060241-068	Sample - Routine		1157	KE	Cafe hall Gals BR Middle Sink	1008	200.5 or 200.8	USEPA	WATER	Y	LEAD
Sch-22310	19060241-069	Sample - Routine		1157	KE	Boiler Rm Sink	1008	200.5 or 200.8	USEPA	WATER	Y	LEAD
Sch-22310	19060241-070	Sample - Routine		1157	KE	Sink to fill of Oven	1008	200.5 or 200.8	USEPA	WATER	Y	LEAD
Sch-22310	19060241-071	Sample - Routine		1157	KE	Sink to fill of Exterior Door	1008	200.5 or 200.8	USEPA	WATER	Y	LEAD
Sch-22310	19060241-072	Sample - Routine		1157	KE	Sink to fill of Dish Washer	1008	200.5 or 200.8	USEPA	WATER	Y	LEAD
Sch-22310	19060241-073	Sample - Routine		1244	KE	Boys Handicap Stall Sink	1008	200.5 or 200.8	USEPA	WATER	Y	LEAD
Sch-22310	19060241-074	Sample - Routine		1244	KE	Boys BR in Sink	1008	200.5 or 200.8	USEPA	WATER	Y	LEAD
Sch-22310	19060241-075	Sample - Routine		1244	KE	Boys BR in Sink	1008	200.5 or 200.8	USEPA	WATER	Y	LEAD
Sch-22310	19060241-076	Sample - Routine		1244	KE	Gals BR in Sink	1008	200.5 or 200.8	USEPA	WATER	Y	LEAD
Sch-22310	19060241-077	Sample - Routine		1244	KE	Gals BR in Sink	1008	200.5 or 200.8	USEPA	WATER	Y	LEAD
Sch-22310	19060241-078	Sample - Routine		1244	KE	Gals BR Handicap Stall Sink	1008	200.5 or 200.8	USEPA	WATER	Y	LEAD
Sch-22310	19060241-079	Sample - Routine		1244	KE	Art Rm 103 in Sink	1008	200.5 or 200.8	USEPA	WATER	Y	LEAD
Sch-22310	19060241-080	Sample - Routine		1221	KE	Art Rm 103 in Sink	1008	200.5 or 200.8	USEPA	WATER	Y	LEAD
Sch-22310	19060241-081	Sample - Routine		1219	KE	Office hall WF	1008	200.5 or 200.8	USEPA	WATER	Y	LEAD
		Sample - Routine					1008	200.5 or 200.8	USEPA	WATER	Y	LEAD
		Sample - Routine					1008	200.5 or 200.8	USEPA	WATER	Y	LEAD
		Sample - Routine					1008	200.5 or 200.8	USEPA	WATER	Y	LEAD

Refill/checked by: [Signature]

Date/Time: 6-25-19 14:15

Received by: [Signature]

Date/Time: 6-25-19 14:15

PES Emergency Exit Routes

191020214

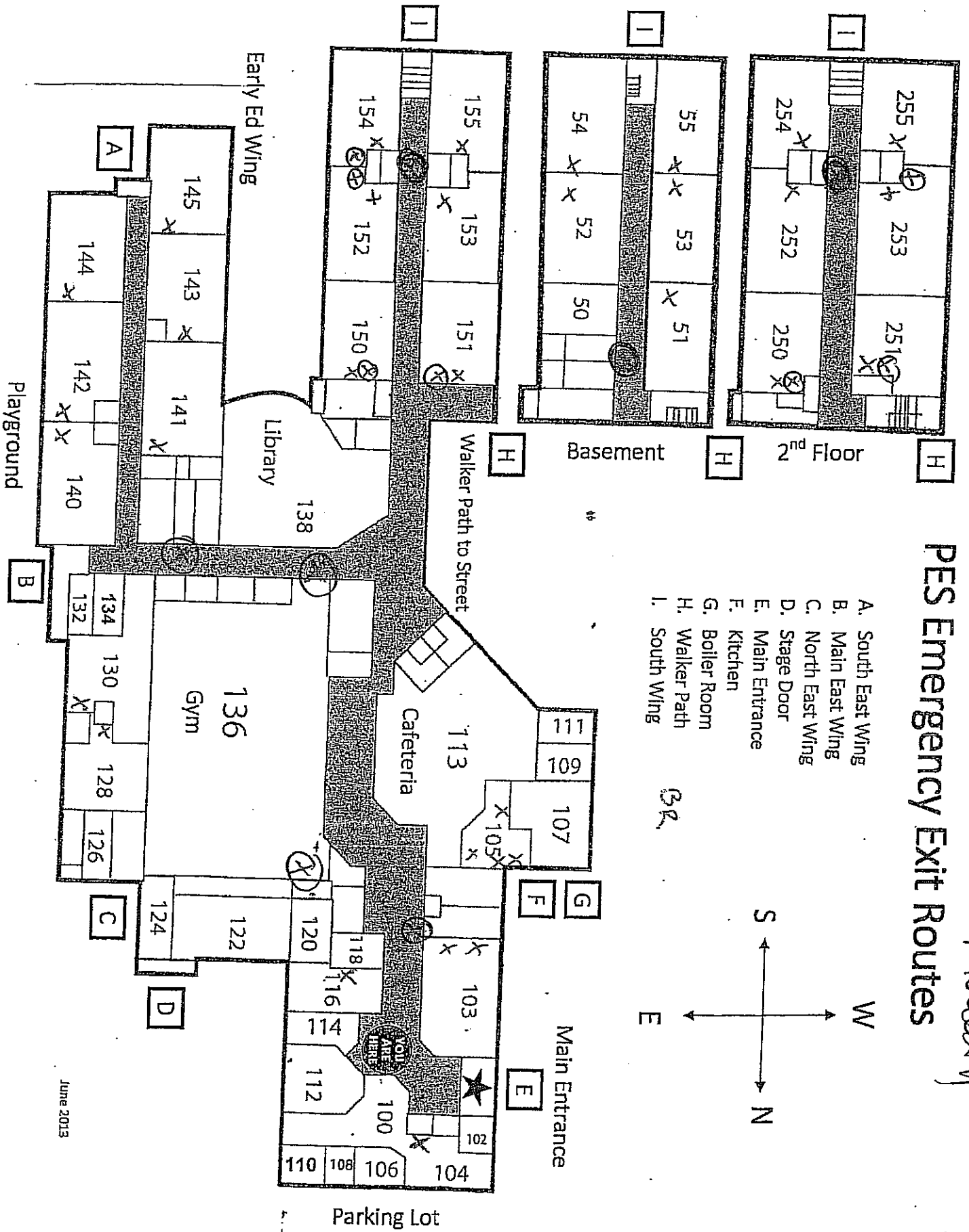

- A. South East Wing
- B. Main East Wing
- C. North East Wing
- D. Stage Door
- E. Main Entrance
- F. Kitchen
- G. Boiler Room
- H. Walker Path
- I. South Wing

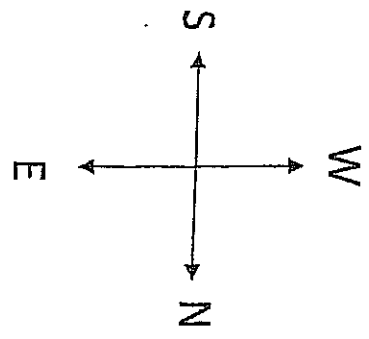

June 2013